

FLOOR PLANS OF RESIDENTIAL PROPERTIES IN THE PHASE 期數的住宅物業的樓面平面圖

LEGEND OF THE TERMS AND ABBREVIATIONS FOR FLOOR PLANS

樓面平面圖中所使用名詞及簡稱之圖例

| | | |
|--|--|--|
| A/C P. | = AIR-CONDITIONER PLATFORM | 冷氣機平台 |
| A/C UNIT AT H/L FOR FLAT X AT X/F | = AIR-CONDITIONER UNIT AT HIGH LEVEL FOR FLAT X AT X/F | X 樓 X 單位之冷氣機室外機於高位 |
| A/C UNIT FOR FLAT X | = AIR-CONDITIONER UNIT FOR FLAT X | X 單位之冷氣機室外機 |
| A/C UNIT FOR FLAT X AT X/F | = AIR-CONDITIONER UNIT FOR FLAT X AT X/F | X 樓 X 單位之冷氣機室外機 |
| A/C UNIT FOR FLAT X AT H/L & FLAT X AT L/L | = AIR-CONDITIONER UNIT FOR FLAT X AT HIGH LEVEL AND FLAT X AT LOW LEVEL | X 單位之冷氣機室外機於高位及 X 單位之冷氣機室外機於低位 |
| A/C UNIT FOR FLAT X OF FISKARS TOWER X | = AIR-CONDITIONER OUTDOOR UNIT FOR FLAT X OF FISKARS TOWER X | FISKARS 第 X 座 X 單位之冷氣機室外機 |
| ACOUSTIC PANEL | = ACOUSTIC PANEL | 隔音板 |
| A.D. | = AIR DUCT | 風管槽 |
| AF / A.F. | = ARCHITECTURAL FEATURE | 建築裝飾 |
| AF ABOVE | = ARCHITECTURAL FEATURE ABOVE | 建築裝飾置上 |
| A.F. LINE ABOVE | = ARCHITECTURAL FEATURE LINE ABOVE | 建築裝飾界線置上 |
| AF LINE ABOVE (FOR X/F ONLY) | = ARCHITECTURAL FEATURE LINE ABOVE (FOR X/F ONLY) | 建築裝飾界線置上(只位於 X 樓) |
| AF M. | = ARCHITECTURAL FEATURE MOULDING | 建築裝飾線條 |
| AF M. ABOVE | = ARCHITECTURAL FEATURE MOULDING ABOVE | 建築裝飾線條置上 |
| AF M. ABOVE (FOR X/F ONLY) / AF M. LINE ABOVE (FOR X/F ONLY) | = ARCHITECTURAL FEATURE MOULDING LINE ABOVE (FOR X/F ONLY) | 建築裝飾線條界線置上(只位於 X 樓) |
| A.FIN AT 5/F, 8/F, 11/F, 16/F, 19/F, 22/F & 26/F H/L | = ARCHITECTURAL FEATURE FINS AT 5/F, 8/F, 11/F, 16/F, 19/F, 22/F & 26/F HIGH LEVEL | 建築裝飾鰭於 5 樓、8 樓、11 樓、16 樓、19 樓、22 樓及 26 樓高位 |
| A.FIN AT 5/F, 8/F, 11/F, 16/F & 19/F H/L | = ARCHITECTURAL FEATURE FINS AT 5/F, 8/F, 11/F, 16/F & 19/F HIGH LEVEL | 建築裝飾鰭於 5 樓、8 樓、11 樓、16 樓及 19 樓高位 |
| A.FIN AT 22/F & 26/F H/L | = ARCHITECTURAL FEATURE FINS AT 22/F & 26/F HIGH LEVEL | 建築裝飾鰭於 22 樓及 26 樓高位 |
| A.FIN AT X/F H/L | = ARCHITECTURAL FEATURE FINS AT X/F HIGH LEVEL | 建築裝飾鰭於 X 樓高位 |
| ALUM CLADDING AT H/L / ALUM. CLADDING AT H/L | = ALUMINIUM CLADDING AT HIGH LEVEL | 鋁面板於高位 |
| BAL. | = BALCONY | 露台 |
| BALCONY LINE ABOVE (FOR X/F ONLY) | = BALCONY LINE ABOVE (FOR X/F ONLY) | 露台界線置上(只位於 X 樓) |
| BATH | = BATHROOM | 浴室 |
| BATH. 1 | = BATHROOM 1 | 浴室 1 |
| BATH. 2 | = BATHROOM 2 | 浴室 2 |
| BR1 | = BEDROOM 1 | 睡房 1 |
| BR2 | = BEDROOM 2 | 睡房 2 |
| BR3 | = BEDROOM 3 | 睡房 3 |
| BUILDING LINE ABOVE | = BUILDING LINE ABOVE | 建築物界線置上 |

Notes:

1. There may be architectural features on external walls of some of the floors.
2. Common pipes exposed and/ or enclosed in cladding are located at/ adjacent to balcony and/ or flat roof and/ or utility platform and/ or air-conditioning platform and/ or external wall and/ or roof of some residential units.
3. There are sunken slabs and/ or ceiling bulkheads at living rooms, dining rooms, bedrooms, utility rooms, corridors, bathrooms, lavatories, open kitchens and kitchens of some residential units for the air-conditioning system and/ or mechanical and electrical service. There are exposed pipes/ ductings for air-conditioning system and/ or mechanical and electrical service within some utility rooms and/ or lavatories.
4. Balconies and utility platforms are non-enclosed areas.
5. Symbols of fittings and fitments shown on the floor plans, such as bathtubs, sink, water closets, shower, sink counter, etc, are architectural symbols retrieved from the latest approved general building plans for general indication only.
6. For some residential units, the air-conditioning platform(s) outside the unit will be placed with air-conditioner outdoor unit(s) belonging to that unit and/ or other residential units.

備註:

1. 部份樓層外牆範圍設有建築裝飾。
2. 部份住宅單位的露台及/或平台及/或工作平台及/或冷氣機平台及/或外牆及/或天台及/或附近設有外露及/或藏於外牆裝飾板內之公用喉管。
3. 部份住宅單位客廳、飯廳、睡房、工作間、走廊、浴室、洗手間、開放式廚房以及廚房天花有跌級樓板及/或假天花用以裝置冷氣系統及/或其他機電設備。部份工作間及/或洗手間內設有冷氣及/或機電設備之外露喉管/管道。
4. 露台及工作平台為不可封閉地方。
5. 樓面平面圖上所顯示的形象裝置符號，例如浴缸、洗滌盆、坐廁、淋浴間、洗滌盆櫃等乃摘自最新的經批准的建築圖則，只作一般性標誌。
6. 部份住宅物業外的冷氣機平台將會放置屬於其單位及/或其他住宅物業的一部或多部冷氣機室外機。

FLOOR PLANS OF RESIDENTIAL PROPERTIES IN THE PHASE 期數的住宅物業的樓面平面圖

LEGEND OF THE TERMS AND ABBREVIATIONS FOR FLOOR PLANS

樓面平面圖中所使用名詞及簡稱之圖例

| | | |
|---|---|------------------|
| BUILDING LINE ABOVE (FOR X/F ONLY)/ BLDG. LINE ABOVE (FOR X/F ONLY) | = BUILDING LINE ABOVE (FOR X/F ONLY) | 建築物界線置上(只位於 X 樓) |
| C.D. | = CABLE DUCT | 電纜槽 |
| COMMON AREA FOR PIPE DUCT MAINTENANCE | = COMMON AREA FOR PIPE DUCT MAINTENANCE | 供管道槽維修用之公用範圍 |
| COMMON FLAT ROOF | = COMMON FLAT ROOF | 公用平台 |
| CORRIDOR | = CORRIDOR | 走廊 |
| D.H. /D.H | = DOG HOUSE | 管道房 |
| DN | = DOWN | 落 |
| EAD | = EXHAUST AIR DUCT | 排氣管道 |
| ELECT. RM. | = ELECTRICAL ROOM | 電力房 |
| ELV /E.L.V | = EXTRA-LOW VOLTAGE DUCT | 特低電壓管道 |
| EMR | = ELECTRICAL METER ROOM | 電錶房 |
| EMR 1 | = ELECTRICAL METER ROOM 1 | 電錶房 1 |
| EMR 2 | = ELECTRICAL METER ROOM 2 | 電錶房 2 |
| FAD | = FRESH AIR DUCT | 鮮風管道 |
| FL. WATER PUMP ROOM | = FLUSHING WATER PUMP ROOM | 沖廁水泵房 |
| FLAT ROOF | = FLAT ROOF | 平台 |
| FLAT ROOF AT X/F | = FLAT ROOF AT X/F | 平台於 X 樓 |
| FLAT ROOF (FOR FLAT X AT X/F) | = FLAT ROOF (FOR FLAT X AT X/F) | X 樓 X 單位之平台 |
| F.S. PUMP ROOM/ F.S. WATER PUMP ROOM | = FIRE SERVICES WATER PUMP ROOM | 消防水泵房 |
| G.M.C / GMC | = GAS METER CABINET | 氣體錶櫃 |
| G.M.C AT BELOW | = GAS METER CABINET AT BELOW | 氣體錶櫃於下 |
| HORIZONTAL PD CLADDING | = HORIZONTAL PIPE DUCT CLADDING | 橫向管道面板 |
| HR | = HOSE REEL | 消防喉轆 |
| HR. AT H/L. | = HOSE REEL AT HIGH LEVEL | 消防喉轆於高位 |
| JACUZZI BATH | = JACUZZI BATH | 按摩浴缸 |
| KIT. | = KITCHEN | 廚房 |
| LAV. /LAV | = LAVATORY | 洗手間 |
| LAV.1 | = LAVATORY 1 | 洗手間 1 |
| LIFT | = LIFT | 升降機 |
| LIFT LOBBY | = LIFT LOBBY | 升降機大堂 |
| LIFT SHAFT | = LIFT SHAFT | 升降機槽 |
| LIV./DIN. | = LIVING ROOM / DINING ROOM | 客廳 / 飯廳 |

Notes:

1. There may be architectural features on external walls of some of the floors.
2. Common pipes exposed and/ or enclosed in cladding are located at/ adjacent to balcony and/ or flat roof and/ or utility platform and/ or air-conditioning platform and/ or external wall and/ or roof of some residential units.
3. There are sunken slabs and/ or ceiling bulkheads at living rooms, dining rooms, bedrooms, utility rooms, corridors, bathrooms, lavatories, open kitchens and kitchens of some residential units for the air-conditioning system and/ or mechanical and electrical service. There are exposed pipes/ ductings for air-conditioning system and/ or mechanical and electrical service within some utility rooms and/ or lavatories.
4. Balconies and utility platforms are non-enclosed areas.
5. Symbols of fittings and fitments shown on the floor plans, such as bathtubs, sink, water closets, shower, sink counter, etc, are architectural symbols retrieved from the latest approved general building plans for general indication only.
6. For some residential units, the air-conditioning platform(s) outside the unit will be placed with air-conditioner outdoor unit(s) belonging to that unit and/ or other residential units.

備註:

1. 部份樓層外牆範圍設有建築裝飾。
2. 部份住宅單位的露台及/或平台及/或工作平台及/或冷氣機平台及/或外牆及/或天台及/或附近設有外露台及/或藏於外牆裝飾板內之公用喉管。
3. 部份住宅單位客廳、飯廳、睡房、工作間、走廊、浴室、洗手間、開放式廚房以及廚房天花有跌級樓板及/或假天花用以裝置冷氣系統及/或其他機電設備。部份工作間及/或洗手間內設有冷氣及/或機電設備之外露喉管/管道。
4. 露台及工作平台為不可封閉地方。
5. 樓面平面圖上所顯示的形象裝置符號，例如浴缸、洗滌盆、坐廁、淋浴間、洗滌盆櫃等乃摘自最新的經批准的建築圖則，只作一般性標誌。
6. 部份住宅物業外的冷氣機平台將會放置屬於其單位及/或其他住宅物業的一部或多部冷氣機室外機。

FLOOR PLANS OF RESIDENTIAL PROPERTIES IN THE PHASE 期數的住宅物業的樓面平面圖

LEGEND OF THE TERMS AND ABBREVIATIONS FOR FLOOR PLANS

樓面平面圖中所使用名詞及簡稱之圖例

| | | |
|-------------------------|---|------------|
| M.BATH | = MASTER BATHROOM | 主人浴室 |
| MBR | = MASTER BEDROOM | 主人睡房 |
| M.L. | = METAL LOUVRE | 金屬百葉 |
| M.L. AT H/L / ML AT H/L | = METAL LOUVRE AT HIGH LEVEL | 金屬百葉於高位 |
| M.L. FOR TOP VENT | = METAL LOUVRE FOR TOP VENT | 頂部通風用金屬百葉 |
| OPEN KIT. | = OPEN KITCHEN | 開放式廚房 |
| REFUGE ROOF | = REFUGE ROOF | 庇護層天台 |
| P.D. | = PIPE DUCT | 管道槽 |
| POT. WATER PUMP ROOM | = POTABLE WATER PUMP ROOM | 食水泵房 |
| R.C. SLAB | = REINFORCED CEMENT CONCRETE SLAB | 鋼筋混凝土樓板 |
| ROOF | = ROOF | 天台 |
| ROOF (FOR FLAT X) | = ROOF (FOR FLAT X) | 天台(屬於單位 X) |
| ROOF (FOR MAINTENANCE) | = ROOF (FOR MAINTENANCE) | 天台(維修用) |
| RS & MRR | = REFUSE STORAGE AND MATERIAL RECOVERY ROOM | 垃圾及物料回收房 |
| SINK | = SINK | 洗手盤 |
| STR. | = STORE | 儲物室 |
| UP | = UP | 上 |
| U.P. | = UTILITY PLATFORM | 工作平台 |
| UTIL. | = UTILITY ROOM | 工作間 |
| WMC | = WATER METER CABINET | 水錶櫃 |
| WMC1 | = WATER METER CABINET 1 | 水錶櫃 1 |
| WMC2 | = WATER METER CABINET 2 | 水錶櫃 2 |
| WMC3 | = WATER METER CABINET 3 | 水錶櫃 3 |
| WMC 4 | = WATER METER CABINET 4 | 水錶櫃 4 |

Notes:

1. There may be architectural features on external walls of some of the floors.
2. Common pipes exposed and/ or enclosed in cladding are located at/ adjacent to balcony and/ or flat roof and/ or utility platform and/ or air-conditioning platform and/ or external wall and/ or roof of some residential units.
3. There are sunken slabs and/ or ceiling bulkheads at living rooms, dining rooms, bedrooms, utility rooms, corridors, bathrooms, lavatories, open kitchens and kitchens of some residential units for the air-conditioning system and/ or mechanical and electrical service. There are exposed pipes/ ductings for air-conditioning system and/ or mechanical and electrical service within some utility rooms and/ or lavatories.
4. Balconies and utility platforms are non-enclosed areas.
5. Symbols of fittings and fitments shown on the floor plans, such as bathtubs, sink, water closets, shower, sink counter, etc, are architectural symbols retrieved from the latest approved general building plans for general indication only.
6. For some residential units, the air-conditioning platform(s) outside the unit will be placed with air-conditioner outdoor unit(s) belonging to that unit and/ or other residential units.

備註:

1. 部份樓層外牆範圍設有建築裝飾。
2. 部份住宅單位的露台及/或平台及/或工作平台及/或冷氣機平台及/或外牆及/或天台及/或附近設有外露及/或藏於外牆裝飾板內之公用喉管。
3. 部份住宅單位客廳、飯廳、睡房、工作間、走廊、浴室、洗手間、開放式廚房以及廚房天花有跌級樓板及/或假天花用以裝置冷氣系統及/或其他機電設備。部份工作間及/或洗手間內設有冷氣及/或機電設備之外露喉管/管道。
4. 露台及工作平台為不可封閉地方。
5. 樓面平面圖上所顯示的形象裝置符號，例如浴缸、洗滌盆、坐廁、淋浴間、洗滌盆櫃等乃摘自最新的經批准的建築圖則，只作一般性標誌。
6. 部份住宅物業外的冷氣機平台將會放置屬於其單位及/或其他住宅物業的一部或多部冷氣機室外機。

FLOOR PLANS OF RESIDENTIAL PROPERTIES IN THE PHASE 期數的住宅物業的樓面平面圖

FISKARS TOWER 1 GARDEN FLOOR (2/F) | FISKARS 第1座花園層(2樓)

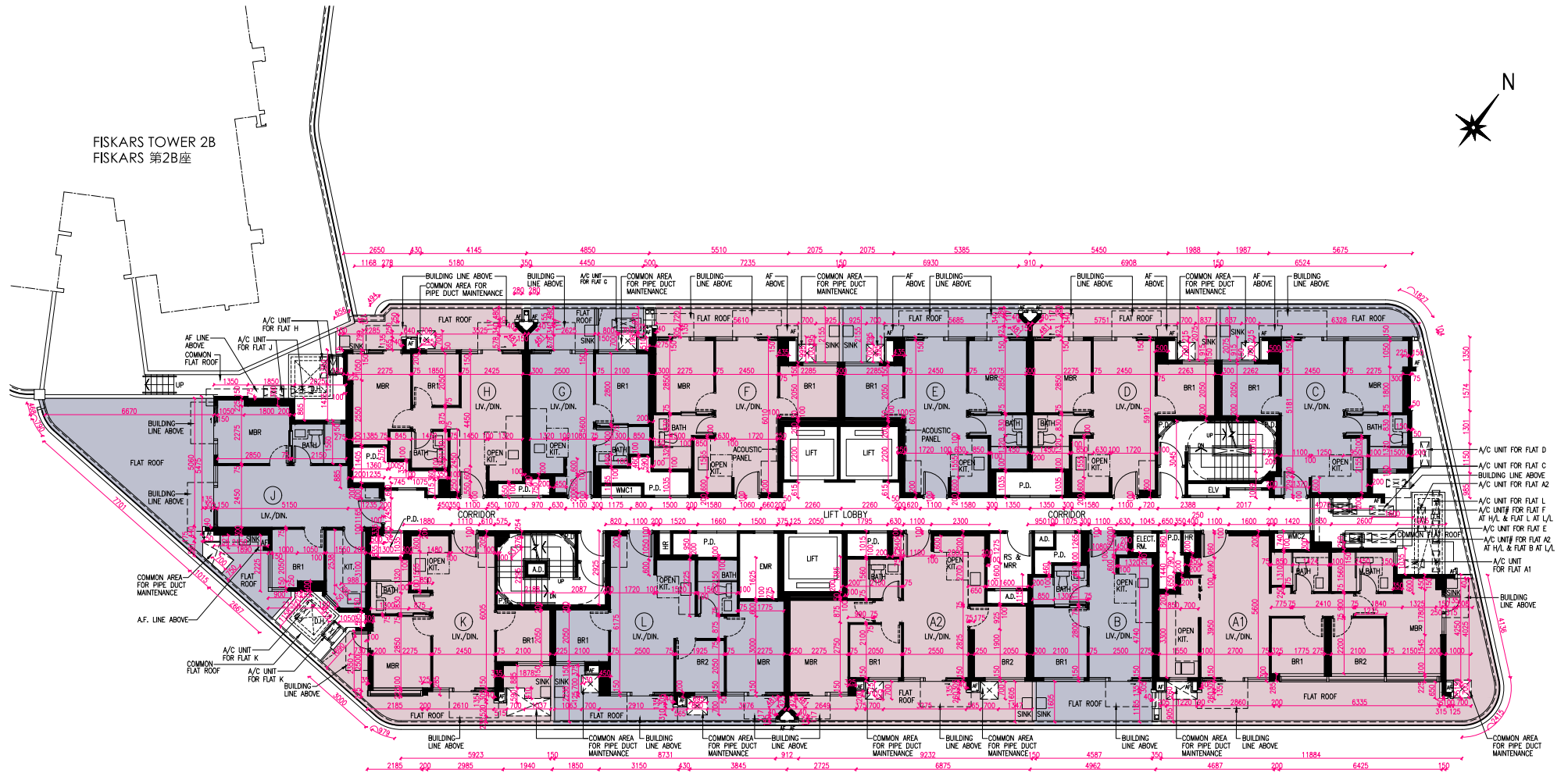

TWO AIR-CONDITIONERS OUTDOOR UNITS WILL BE INSTALLED WITH A DOUBLE DECK SYSTEM
 # 兩部冷氣機室外機將會以雙層系統型式安裝

Scale 比例 Metres 米 0 2 4 6 8

FLOOR PLANS OF RESIDENTIAL PROPERTIES IN THE PHASE 期數的住宅物業的樓面平面圖

| | | Floor 樓層 | Flat 單位 | | | | | | | | | | | |
|----------------------------------|--|---------------------------------|---------------------------------|-----------------------------|------------------------|------------------------|------------------------|------------------------|------------------------|------------------------|------------------------|---------------------------------|------------------------|-----------------------------|
| | | | A1 | A2 | B | C | D | E | F | G | H | J | K | L |
| Fiskars Tower 1 Fiskars 第 1 座 | Floor-to-floor height of each residential property (mm) 每個住宅物業的層與層之間的高度(毫米) | Garden Floor (2/F) 花園層 (2 樓) | 2850, 2900, 3050, 3150 | 2850, 3050, 3150 | 2850, 3050, 3150 | 2850, 3050, 3150 | 2850, 3050, 3150 | 2850, 3050, 3150 | 2850, 3050, 3150 | 2850, 3050, 3150 | 2850, 3050, 3150 | 2850, 2900, 3050, 3150 | 2850, 3050, 3150 | 2850, 3050, 3150 |
| | The thickness of the floor slabs (excluding plaster) of each residential property (mm) 每個住宅物業的樓板的厚度 (不包括灰泥)(毫米) | Garden Floor (2/F) 花園層 (2 樓) | 150, 175, 200 | 150, 175, 200, 300 | 175 | 150, 175, 200 | 150, 175 | 150, 175 | 150, 175 | 175 | 175, 200, 300 | 150, 175, 200 | 150, 175, 200 | 150, 175, 200, 500 |

The internal areas of the residential properties on the upper floors will generally be slightly larger than those on the lower floors because of the reducing thickness of the structural walls on the upper floors. (This does not apply to the residential properties in the Phase because the design of the Phase does not involve reducing thickness of structural walls of residential properties on the upper floors and hence internal areas of those residential properties will not be increased.)

因住宅物業的較高樓層的結構牆的厚度遞減，較高樓層的內部面積，一般比較低樓層的內部面積稍大。（不適用於期數內的住宅物業，因為期數的設計是不牽涉較高樓層的住宅物業的結構牆的厚度遞減。因此，該等住宅物業的內部面積不會增加。）

Notes:

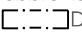
- The dimensions of floor plans are all structural dimensions in millimetre.
- Please refer to Pages AL001 to AL003 of this sales brochure for notes, legend of the terms and abbreviations shown in the floor plan.
-  Dotted line in a residential unit with open kitchen delineates the extent of open kitchen area.

備註:

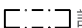
- 平面圖所列之尺寸數字為毫米標示的建築結構尺寸。
- 平面圖中顯示之備註、名詞及簡稱圖例請參閱本售樓說明書第AL001至AL003頁。
-  設有開放式廚房的住宅單位內所顯示的虛線代表開放式廚房範圍。

FLOOR PLANS OF RESIDENTIAL PROPERTIES IN THE PHASE 期數的住宅物業的樓面平面圖

FISKARS TOWER 1 3/F, 5/F-12/F & 15/F-21/F | FISKARS 第1座 3樓、5樓至12樓及15樓至21樓

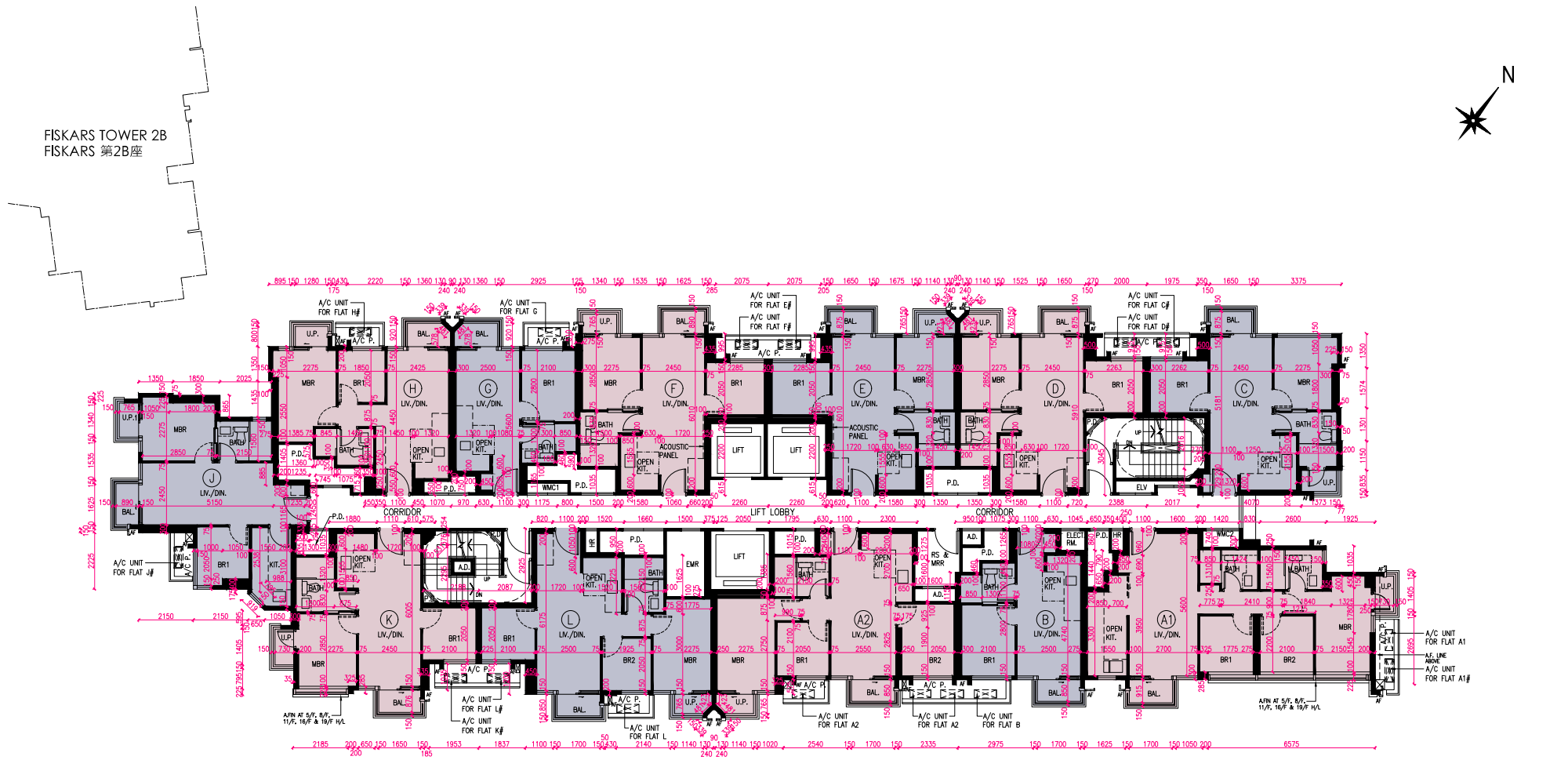

TWO AIR-CONDITIONERS OUTDOOR UNITS WILL BE INSTALLED WITH A DOUBLE DECK SYSTEM

兩部冷氣機室外機將會以雙層系統型式安裝

Scale 比例 Metres 米 0 2 4 6 8

FLOOR PLANS OF RESIDENTIAL PROPERTIES IN THE PHASE 期數的住宅物業的樓面平面圖

| | | Floor 樓層 | Flat 單位 | | | | | | | | | | | |
|----------------------------------|--|--|---------------------------------|-----------------------------|------------------------|------------------------|------------------------|------------------------|------------------------|------------------------|------------------------|---------------------------------|------------------------|-----------------------------|
| | | | A1 | A2 | B | C | D | E | F | G | H | J | K | L |
| Fiskars Tower 1 Fiskars 第 1 座 | Floor-to-floor height of each residential property (mm) 每個住宅物業的層與層之間的高度 (毫米) | 3/F, 5/F-12/F & 15/F-21/F 3 樓、5 樓至 12 樓及 15 樓至 21 樓 | 2850, 2900, 3050, 3150 | 2850, 3050, 3150 | 2850, 3050, 3150 | 2850, 3050, 3150 | 2850, 3050, 3150 | 2850, 3050, 3150 | 2850, 3050, 3150 | 2850, 3050, 3150 | 2850, 3050, 3150 | 2850, 2900, 3050, 3150 | 2850, 3050, 3150 | 2850, 3050, 3150 |
| | The thickness of the floor slabs (excluding plaster) of each residential property (mm) 每個住宅物業的樓板的厚度 (不包括灰泥)(毫米) | 3/F, 5/F-12/F & 15/F-21/F 3 樓、5 樓至 12 樓及 15 樓至 21 樓 | 150, 175, 200 | 150, 175, 200, 300 | 175 | 150, 175, 200 | 150, 175 | 150, 175 | 150, 175 | 175 | 175, 200, 300 | 150, 175, 200 | 150, 175, 200 | 150, 175, 200, 500 |

The internal areas of the residential properties on the upper floors will generally be slightly larger than those on the lower floors because of the reducing thickness of the structural walls on the upper floors. (This does not apply to the residential properties in the Phase because the design of the Phase does not involve reducing thickness of structural walls of residential properties on the upper floors and hence internal areas of those residential properties will not be increased.)

因住宅物業的較高樓層的結構牆的厚度遞減，較高樓層的內部面積，一般比較低樓層的內部面積稍大。（不適用於期數內的住宅物業，因為期數的設計是不牽涉較高樓層的住宅物業的結構牆的厚度遞減。因此，該等住宅物業的內部面積不會增加。）

Notes:

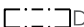
- The dimensions of floor plans are all structural dimensions in millimetre.
- Please refer to Pages AL001 to AL003 of this sales brochure for notes, legend of the terms and abbreviations shown in the floor plan.
-  Dotted line in a residential unit with open kitchen delineates the extent of open kitchen area.

備註:

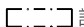
- 平面圖所列之尺寸數字為毫米標示的建築結構尺寸。
- 平面圖中顯示之備註、名詞及簡稱圖例請參閱本售樓說明書第AL001至AL003頁。
-  設有開放式廚房的住宅單位內所顯示的虛線代表開放式廚房範圍。

FLOOR PLANS OF RESIDENTIAL PROPERTIES IN THE PHASE 期數的住宅物業的樓面平面圖

FISKARS TOWER 1 22/F-23/F & 25/F-27/F | FISKARS 第1座 22樓至23樓及25樓至27樓

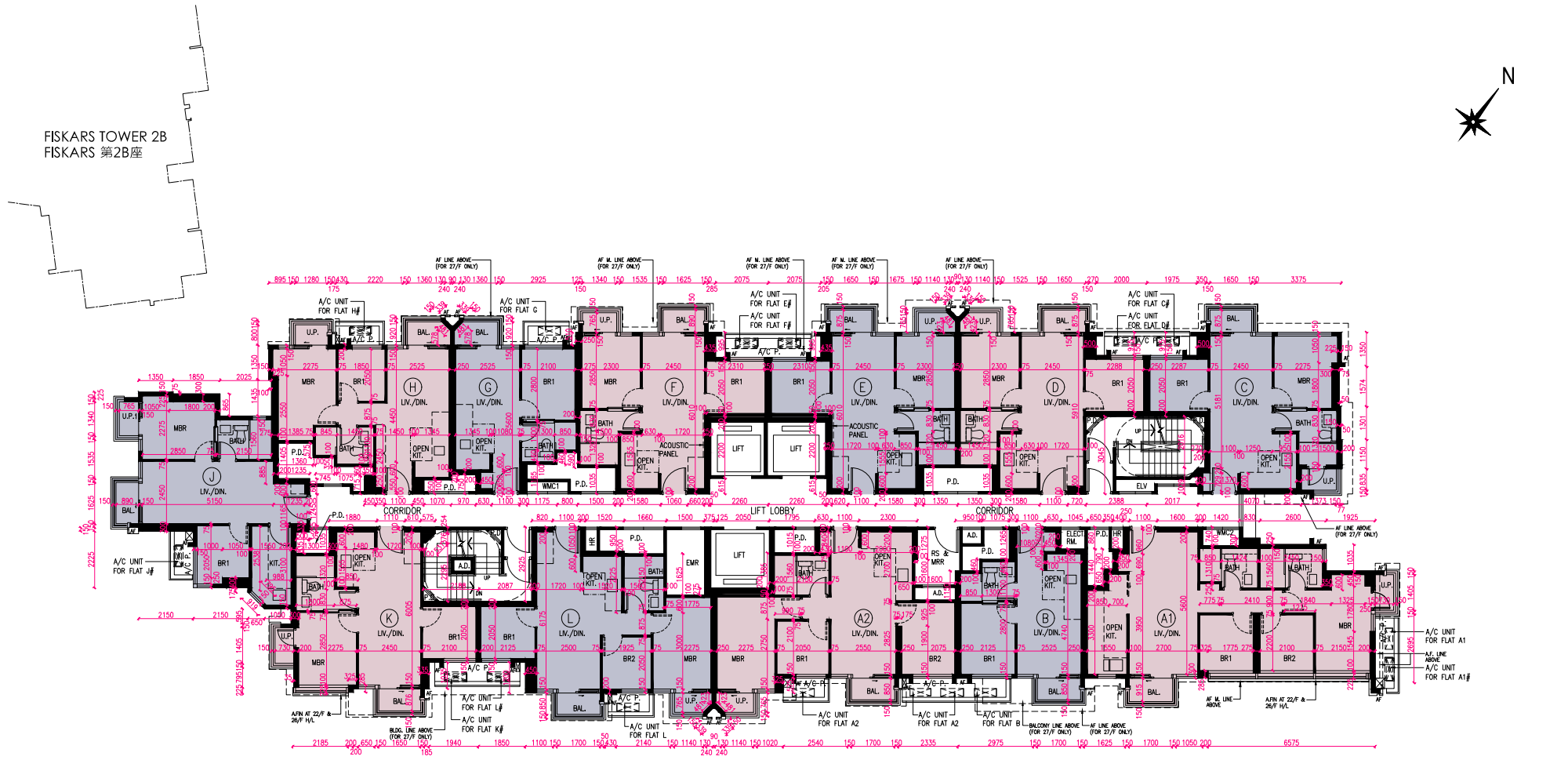

TWO AIR-CONDITIONERS OUTDOOR UNITS WILL BE INSTALLED WITH A DOUBLE DECK SYSTEM
 # 兩部冷氣機室外機將會以雙層系統型式安裝

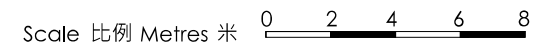

FLOOR PLANS OF RESIDENTIAL PROPERTIES IN THE PHASE 期數的住宅物業的樓面平面圖

| | | Floor 樓層 | Flat 單位 | | | | | | | | | | | | |
|----------------------------------|--|--|---|---------------------------------|------------------------|---|--|---------------------------------|---------------------------------|---------------------------------|------------------------|---------------------------------|--|------------------------|-----------------------------|
| | | | A1 | A2 | B | C | D | E | F | G | H | J | K | L | |
| Fiskars Tower 1 Fiskars 第 1 座 | Floor-to-floor height of each residential property (mm) 每個住宅物業的層與層之間的高度 (毫米) | 22/F, 23/F, 25/F & 26/F 22 樓、23 樓、 25 樓及 26 樓 | 2850, 2900, 3050, 3150 | 2850, 3050, 3150 | 2850, 3050, 3150 | 2850, 3050, 3150 | 2850, 3050, 3150 | 2850, 3050, 3150 | 2850, 3050, 3150 | 2850, 3050, 3150 | 2850, 3050, 3150 | 2850, 2900, 3050, 3150 | 2850, 3050, 3150 | 2850, 3050, 3150 | |
| | Floor-to-floor height of each residential property (mm) 每個住宅物業的層與層之間的高度 (毫米) | 27/F 27 樓 | 3150, 3175, 3200, 3345 3500 | 3150, 3200, 3395, 3500 | 3395, 3500 | 3175, 3200, 3345, 3395, 3400, 3500 | 3150, 3200, 3395, 3400, 3500 | 3150, 3200, 3395, 3500 | 3150, 3200, 3395, 3500 | 3150, 3200, 3395, 3500 | 3395, 3500 | 3150, 3395, 3400, 3500 | 3100, 3150, 3200, 3345, 3395, 3400, 3500 | 3395, 3500 | 3150, 3395, 3500 |
| | The thickness of the floor slabs (excluding plaster) of each residential property (mm) 每個住宅物業的樓板的厚度 (不包括灰泥)(毫米) | 22/F, 23/F, 25/F & 26/F 22 樓、23 樓、 25 樓及 26 樓 | 150, 175, 200 | 150, 175, 200, 300 | 175 | 150, 175, 200 | 150, 175 | 150, 175 | 150, 175 | 150, 175 | 175 | 175, 200, 300 | 150, 175, 200 | 150, 175, 200 | 150, 175, 200, 500 |
| | The thickness of the floor slabs (excluding plaster) of each residential property (mm) 每個住宅物業的樓板的厚度 (不包括灰泥)(毫米) | 27/F 27 樓 | 150, 200, 225, 500 | 150, 200, 225, 500 | 150, 175 | 150, 200, 500 | 150, 200, 500, 550 | 150 | 150, 450 | 150, 175 | 150, 200, 550 | 150, 200, 500 | 150, 200 | 150, 225, 500 | |

The internal areas of the residential properties on the upper floors will generally be slightly larger than those on the lower floors because of the reducing thickness of the structural walls on the upper floors. (This does not apply to the residential properties in the Phase because the design of the Phase does not involve reducing thickness of structural walls of residential properties on the upper floors and hence internal areas of those residential properties will not be increased.)

因住宅物業的較高樓層的結構牆的厚度遞減，較高樓層的內部面積，一般比較低樓層的內部面積稍大。(不適用於期數內的住宅物業，因為期數的設計是不牽涉較高樓層的住宅物業的結構牆的厚度遞減。因此，該等住宅物業的內部面積不會增加。)

Notes:

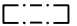
- The dimensions of floor plans are all structural dimensions in millimetre.
- Please refer to Pages AL001 to AL003 of this sales brochure for notes, legend of the terms and abbreviations shown in the floor plan.
-  Dotted line in a residential unit with open kitchen delineates the extent of open kitchen area.

備註:

- 平面圖所列之尺寸數字為毫米標示的建築結構尺寸。
- 平面圖中顯示之備註、名詞及簡稱圖例請參閱本售樓說明書第AL001至AL003頁。
-  設有開放式廚房的住宅單位內所顯示的虛線代表開放式廚房範圍。

FLOOR PLANS OF RESIDENTIAL PROPERTIES IN THE PHASE 期數的住宅物業的樓面平面圖

FISKARS TOWER 1 PENTHOUSE FLOOR (28/F) | FISKARS 第1座 頂層 (28樓)

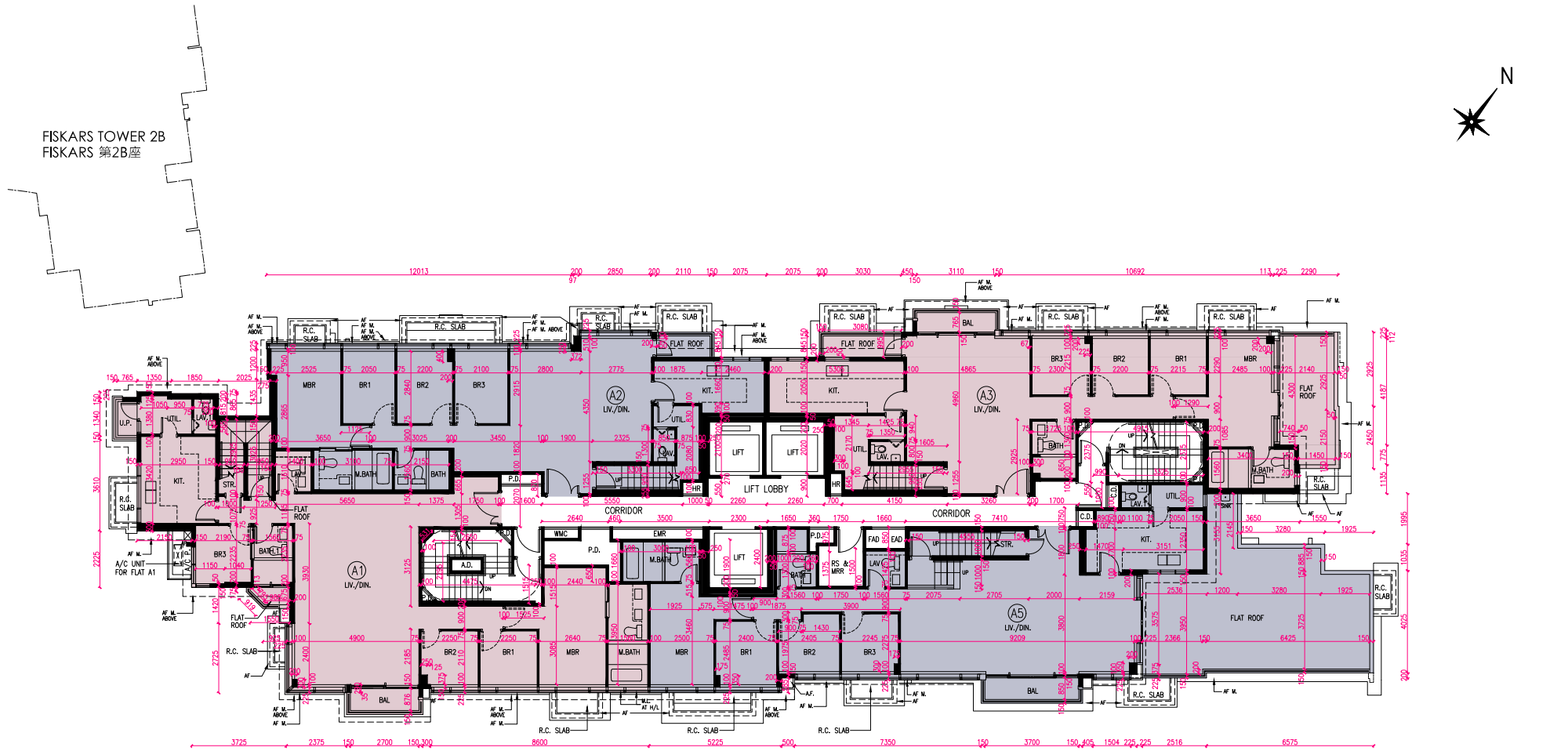

TWO AIR-CONDITIONERS OUTDOOR UNITS WILL BE INSTALLED WITH A DOUBLE DECK SYSTEM

兩部冷氣機室外機將會以雙層系統型式安裝

Scale 比例 Metres 米

FLOOR PLANS OF RESIDENTIAL PROPERTIES IN THE PHASE 期數的住宅物業的樓面平面圖

| | | Floor 樓層 | Flat 單位 | | | |
|----------------------------------|--|-------------------------------------|------------------------|---------------|---------------------------------|------------------------|
| | | | A1 | A2 | A3 | A5 |
| Fiskars Tower 1 Fiskars 第 1 座 | Floor-to-floor height of each residential property (mm) 每個住宅物業的層與層之間的高度 (毫米) | Penthouse Floor (28/F) 頂層 (28 樓) | 3500, 3700, 3725 | 3500, 3700 | 3500, 3700, 3725, 3825 | 3500, 3700, 3725 |
| | The thickness of the floor slabs (excluding plaster) of each residential property (mm) 每個住宅物業的樓板的厚度 (不包括灰泥)(毫米) | Penthouse Floor (28/F) 頂層 (28 樓) | 150, 200, 225 | 200, 400 | 150, 200 | 150, 200, 400 |

The internal areas of the residential properties on the upper floors will generally be slightly larger than those on the lower floors because of the reducing thickness of the structural walls on the upper floors. (This does not apply to the residential properties in the Phase because the design of the Phase does not involve reducing thickness of structural walls of residential properties on the upper floors and hence internal areas of those residential properties will not be increased.)

因住宅物業的較高樓層的結構牆的厚度遞減，較高樓層的內部面積，一般比較低樓層的內部面積稍大。(不適用於期數內的住宅物業，因為期數的設計是不牽涉較高樓層的住宅物業的結構牆的厚度遞減。因此，該等住宅物業的內部面積不會增加。)

Notes:

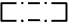
- The dimensions of floor plans are all structural dimensions in millimetre.
- Please refer to Pages AL001 to AL003 of this sales brochure for notes, legend of the terms and abbreviations shown in the floor plan.
-  Dotted line in a residential unit with open kitchen delineates the extent of open kitchen area.

備註:

- 平面圖所列之尺寸數字為毫米標示的建築結構尺寸。
- 平面圖中顯示之備註、名詞及簡稱圖例請參閱本售樓說明書第AL001至AL003頁。
-  設有開放式廚房的住宅單位內所顯示的虛線代表開放式廚房範圍。

FLOOR PLANS OF RESIDENTIAL PROPERTIES IN THE PHASE 期數的住宅物業的樓面平面圖

FISKARS TOWER 1 ROOF | FISKARS 第1座天台

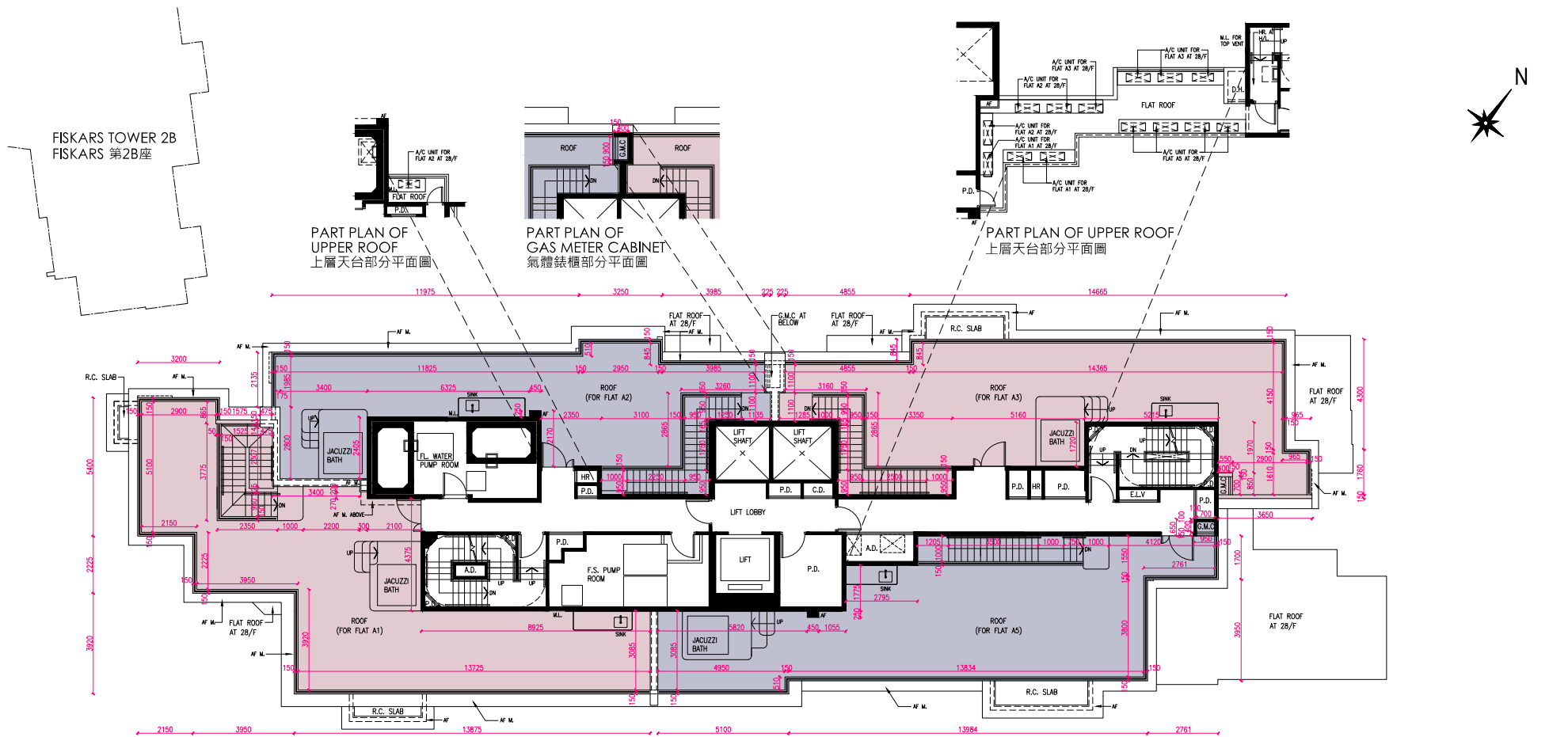

Scale 比例 Metres 米 0 2 4 6 8

FLOOR PLANS OF RESIDENTIAL PROPERTIES IN THE PHASE 期數的住宅物業的樓面平面圖

| | | Floor 樓層 | Flat 單位 | | | |
|----------------------------------|--|-------------|-----------------------|-----------------------|-----------------------|-----------------------|
| | | | A1 | A2 | A3 | A5 |
| Fiskars Tower 1 Fiskars 第 1 座 | Floor-to-floor height of each residential property (mm) 每個住宅物業的層與層之間的高度 (毫米) | Roof 天台 | Not Applicable 不適用 | Not Applicable 不適用 | Not Applicable 不適用 | Not Applicable 不適用 |
| | The thickness of the floor slabs (excluding plaster) of each residential property (mm) 每個住宅物業的樓板的厚度 (不包括灰泥)(毫米) | Roof 天台 | Not Applicable 不適用 | Not Applicable 不適用 | Not Applicable 不適用 | Not Applicable 不適用 |

The internal areas of the residential properties on the upper floors will generally be slightly larger than those on the lower floors because of the reducing thickness of the structural walls on the upper floors. (This does not apply to the residential properties in the Phase because the design of the Phase does not involve reducing thickness of structural walls of residential properties on the upper floors and hence internal areas of those residential properties will not be increased.)

因住宅物業的較高樓層的結構牆的厚度遞減，較高樓層的內部面積，一般比較低樓層的內部面積稍大。(不適用於期數內的住宅物業，因為期數的設計是不牽涉較高樓層的住宅物業的結構牆的厚度遞減。因此，該等住宅物業的內部面積不會增加。)

Notes:

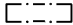
- The dimensions of floor plans are all structural dimensions in millimetre.
- Please refer to Pages AL001 to AL003 of this sales brochure for notes, legend of the terms and abbreviations shown in the floor plan.
-  Dotted line in a residential unit with open kitchen delineates the extent of open kitchen area.

備註:

- 平面圖所列之尺寸數字為毫米標示的建築結構尺寸。
- 平面圖中顯示之備註、名詞及簡稱圖例請參閱本售樓說明書第AL001至AL003頁。
-  設有開放式廚房的住宅單位內所顯示的虛線代表開放式廚房範圍。

FLOOR PLANS OF RESIDENTIAL PROPERTIES IN THE PHASE 期數的住宅物業的樓面平面圖

FISKARS TOWER 2A GARDEN FLOOR (2/F) | FISKARS 第2A座花園層(2樓)



PART PLAN OF GARDEN FLOOR (2/F) OF FISKARS TOWER 2B (REFER TO AL028)
FISKARS 第2B座花園層(2樓) 部分平面圖 (參閱AL028)

FISKARS TOWER 2B
FISKARS 第2B座

TWO AIR-CONDITIONERS OUTDOOR UNITS WILL BE INSTALLED WITH A DOUBLE DECK SYSTEM
兩部冷氣機室外機將會以雙層系統型式安裝

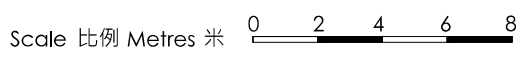

FLOOR PLANS OF RESIDENTIAL PROPERTIES IN THE PHASE 期數的住宅物業的樓面平面圖

| | | Floor 樓層 | Flat 單位 | | | | | | | | | |
|----------------------------------|--|--------------------------------|---------------------------------|---------------------------------|------------------------|------------------------|------------------------|------------------------|------------------------|------------------------|------------------------|------------------------|
| | | | A1 | A2 | B | C | D | E | F | G | H | J |
| Fiskars Tower 2A Fiskars 第2A座 | Floor-to-floor height of each residential property (mm) 每個住宅物業的層與層之間的高度 (毫米) | Garden Floor (2/F) 花園層 (2樓) | 2850, 2900, 3050, 3150 | 2700, 2850, 3050, 3150 | 2850, 3050, 3150 | 2850, 3050, 3150 | 2850, 3050, 3150 | 2850, 3050, 3150 | 2850, 3050, 3150 | 2850, 3050, 3150 | 2850, 3050, 3150 | 2850, 3050, 3150 |
| | The thickness of the floor slabs (excluding plaster) of each residential property (mm) 每個住宅物業的樓板的厚度 (不包括灰泥)(毫米) | Garden Floor (2/F) 花園層 (2樓) | 150, 175 | 150, 175 | 150, 175 | 150, 175 | 150, 175 | 150, 175 | 175, 200 | 175, 200 | 150, 175 | 150, 175, 200 |

The internal areas of the residential properties on the upper floors will generally be slightly larger than those on the lower floors because of the reducing thickness of the structural walls on the upper floors. (This does not apply to the residential properties in the Phase because the design of the Phase does not involve reducing thickness of structural walls of residential properties on the upper floors and hence internal areas of those residential properties will not be increased.)

因住宅物業的較高樓層的結構牆的厚度遞減，較高樓層的內部面積，一般比較低樓層的內部面積稍大。（不適用於期數內的住宅物業，因為期數的設計是不牽涉較高樓層的住宅物業的結構牆的厚度遞減。因此，該等住宅物業的內部面積不會增加。）

Notes:

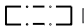
- The dimensions of floor plans are all structural dimensions in millimetre.
- Please refer to Pages AL001 to AL003 of this sales brochure for notes, legend of the terms and abbreviations shown in the floor plan.
-  Dotted line in a residential unit with open kitchen delineates the extent of open kitchen area.

備註:

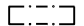
- 平面圖所列之尺寸數字為毫米標示的建築結構尺寸。
- 平面圖中顯示之備註、名詞及簡稱圖例請參閱本售樓說明書第AL001至AL003頁。
-  設有開放式廚房的住宅單位內所顯示的虛線代表開放式廚房範圍。

FLOOR PLANS OF RESIDENTIAL PROPERTIES IN THE PHASE 期數的住宅物業的樓面平面圖

FISKARS TOWER 2A 3/F, 5/F-12/F, 15/F-23/F & 25/F-26/F | FISKARS 第2A座 3樓、5樓至12樓、15樓至23樓及25樓至26樓



FISKARS TOWER 2B
FISKARS 第2B座

TWO AIR-CONDITIONERS OUTDOOR UNITS WILL BE INSTALLED WITH A DOUBLE DECK SYSTEM
兩部冷氣機室外機將會以雙層系統型式安裝

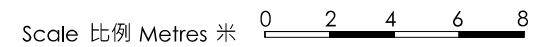

FLOOR PLANS OF RESIDENTIAL PROPERTIES IN THE PHASE 期數的住宅物業的樓面平面圖

| | | Floor 樓層 | Flat 單位 | | | | | | | | | | |
|---------------------------------------|--|--|---------------------------------|---------------------------------|------------------------|------------------------|------------------------|------------------------|------------------------|------------------------|------------------------|------------------------|---------------------|
| | | | A1 | A2 | B | C | D | E | F | G | H | J | |
| Fiskars Tower 2A Fiskars 第 2A 座 | Floor-to-floor height of each residential property (mm) 每個住宅物業的層與層之間的高度 (毫米) | 3/F, 5/F-12/F, 15/F-23/F & 25/F 3 樓、5 樓至 12 樓、 15 樓至 23 樓及 25 樓 | 2850, 2900, 3050, 3150 | 2700, 2850, 3050, 3150 | 2850, 3050, 3150 | 2850, 3050, 3150 | 2850, 3050, 3150 | 2850, 3050, 3150 | 2850, 3050, 3150 | 2850, 3050, 3150 | 2850, 3050, 3150 | 2850, 3050, 3150 | |
| | Floor-to-floor height of each residential property (mm) 每個住宅物業的層與層之間的高度 (毫米) | 26/F 26 樓 | 2850, 2900, 3050, 3150 | 2850, 3050, 3150 | 2850, 3050, 3150 | 2850, 3050, 3150 | 2850, 3050, 3150 | 2850, 3050, 3150 | 2850, 3050, 3150 | 2850, 3050, 3150 | 2850, 3150 | 3150 | |
| | The thickness of the floor slabs (excluding plaster) of each residential property (mm) 每個住宅物業的樓板的厚度 (不包括灰泥)(毫米) | 3/F, 5/F-12/F, 15/F-23/F & 25/F 3 樓、5 樓至 12 樓、 15 樓至 23 樓及 25 樓 | 150, 175 | 150, 175 | 150, 175 | 150, 175 | 150, 175 | 150, 175 | 150, 175 | 175, 200 | 175, 200 | 150, 175 | 150, 175, 200 |
| | The thickness of the floor slabs (excluding plaster) of each residential property (mm) 每個住宅物業的樓板的厚度 (不包括灰泥)(毫米) | 26/F 26 樓 | 150, 175 | 150, 175 | 150, 175 | 150, 175 | 150, 175 | 150, 175 | 150, 175 | 200, 175, 500 | 175, 200 | 150, 175, 200 | 175, 200 |

The internal areas of the residential properties on the upper floors will generally be slightly larger than those on the lower floors because of the reducing thickness of the structural walls on the upper floors. (This does not apply to the residential properties in the Phase because the design of the Phase does not involve reducing thickness of structural walls of residential properties on the upper floors and hence internal areas of those residential properties will not be increased.)

因住宅物業的較高樓層的結構牆的厚度遞減，較高樓層的內部面積，一般比較低樓層的內部面積稍大。（不適用於期數內的住宅物業，因為期數的設計是不牽涉較高樓層的住宅物業的結構牆的厚度遞減。因此，該等住宅物業的內部面積不會增加。）

Notes:

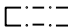
- The dimensions of floor plans are all structural dimensions in millimetre.
- Please refer to Pages AL001 to AL003 of this sales brochure for notes, legend of the terms and abbreviations shown in the floor plan.
-  Dotted line in a residential unit with open kitchen delineates the extent of open kitchen area.

備註:

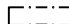
- 平面圖所列之尺寸數字為毫米標示的建築結構尺寸。
- 平面圖中顯示之備註、名詞及簡稱圖例請參閱本售樓說明書第AL001至AL003頁。
-  設有開放式廚房的住宅單位內所顯示的虛線代表開放式廚房範圍。

FLOOR PLANS OF RESIDENTIAL PROPERTIES IN THE PHASE 期數的住宅物業的樓面平面圖

FISKARS TOWER 2A 27/F | FISKARS 第2A座27樓



FISKARS TOWER 2B
FISKARS 第2B座

TWO AIR-CONDITIONERS OUTDOOR UNITS WILL BE INSTALLED WITH A DOUBLE DECK SYSTEM
兩部冷氣機室外機將會以雙層系統型式安裝

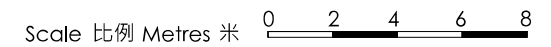

FLOOR PLANS OF RESIDENTIAL PROPERTIES IN THE PHASE 期數的住宅物業的樓面平面圖

| | | Floor 樓層 | Flat 單位 | | | | | | | |
|------------------------------------|--|--------------|---------------------------------|------------------------|------------------------|------------------------|------------------------|------------------------|------------------------|---------------------------------|
| | | | A1 | A2 | B | C | D | E | F | G |
| Fiskars Tower 2A Fiskars 第 2A 座 | Floor-to-floor height of each residential property (mm) 每個住宅物業的層與層之間的高度 (毫米) | 27/F 27 樓 | 2850, 2900, 3050, 3150 | 2850, 3050, 3150 | 2850, 3050, 3150 | 2850, 3050, 3150 | 2850, 3050, 3150 | 2850, 3050, 3150 | 2850, 3050, 3150 | 2850, 2900, 3050, 3150 |
| | The thickness of the floor slabs (excluding plaster) of each residential property (mm) 每個住宅物業的樓板的厚度 (不包括灰泥)(毫米) | 27/F 27 樓 | 150, 175 | 150, 175 | 150, 175 | 150, 175 | 150, 175 | 150, 175 | 150, 175 | 200, 175, 500 |

The internal areas of the residential properties on the upper floors will generally be slightly larger than those on the lower floors because of the reducing thickness of the structural walls on the upper floors. (This does not apply to the residential properties in the Phase because the design of the Phase does not involve reducing thickness of structural walls of residential properties on the upper floors and hence internal areas of those residential properties will not be increased.)

因住宅物業的較高樓層的結構牆的厚度遞減，較高樓層的內部面積，一般比較低樓層的內部面積稍大。（不適用於期數內的住宅物業，因為期數的設計是不牽涉較高樓層的住宅物業的結構牆的厚度遞減。因此，該等住宅物業的內部面積不會增加。）

Notes:

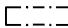
- The dimensions of floor plans are all structural dimensions in millimetre.
- Please refer to Pages AL001 to AL003 of this sales brochure for notes, legend of the terms and abbreviations shown in the floor plan.
-  Dotted line in a residential unit with open kitchen delineates the extent of open kitchen area.

備註:

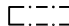
- 平面圖所列之尺寸數字為毫米標示的建築結構尺寸。
- 平面圖中顯示之備註、名詞及簡稱圖例請參閱本售樓說明書第AL001至AL003頁。
-  設有開放式廚房的住宅單位內所顯示的虛線代表開放式廚房範圍。

FLOOR PLANS OF RESIDENTIAL PROPERTIES IN THE PHASE 期數的住宅物業的樓面平面圖

FISKARS TOWER 2A 28/F | FISKARS 第2A座28樓



FISKARS TOWER 2B
FISKARS 第2B座

TWO AIR-CONDITIONERS OUTDOOR UNITS WILL BE INSTALLED WITH A DOUBLE DECK SYSTEM
兩部冷氣機室外機將會以雙層系統型式安裝

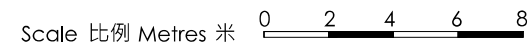

FLOOR PLANS OF RESIDENTIAL PROPERTIES IN THE PHASE 期數的住宅物業的樓面平面圖

| | | Floor 樓層 | Flat 單位 | | | | | | | |
|----------------------------------|--|-------------|---------------------------------|---------------------------------|------------------------|------------------------|------------------------|------------------------|------------------------|---------------------------------|
| | | | A1 | A2 | B | C | D | E | F | G |
| Fiskars Tower 2A Fiskars 第2A座 | Floor-to-floor height of each residential property (mm) 每個住宅物業的層與層之間的高度 (毫米) | 28/F 28樓 | 2850, 2900, 3050, 3150 | 2700, 2850, 3050, 3150 | 2850, 3050, 3150 | 2850, 3050, 3150 | 2850, 3050, 3150 | 2850, 3050, 3150 | 2850, 3050, 3150 | 2850, 2900, 3050, 3150 |
| | The thickness of the floor slabs (excluding plaster) of each residential property (mm) 每個住宅物業的樓板的厚度 (不包括灰泥)(毫米) | 28/F 28樓 | 150, 175 | 150, 175 | 150, 175 | 150, 175 | 150, 175 | 150, 175 | 150, 175 | 175, 200, 500 |

The internal areas of the residential properties on the upper floors will generally be slightly larger than those on the lower floors because of the reducing thickness of the structural walls on the upper floors. (This does not apply to the residential properties in the Phase because the design of the Phase does not involve reducing thickness of structural walls of residential properties on the upper floors and hence internal areas of those residential properties will not be increased.)

因住宅物業的較高樓層的結構牆的厚度遞減，較高樓層的內部面積，一般比較低樓層的內部面積稍大。（不適用於期數內的住宅物業，因為期數的設計是不牽涉較高樓層的住宅物業的結構牆的厚度遞減。因此，該等住宅物業的內部面積不會增加。）

Notes:

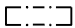
- The dimensions of floor plans are all structural dimensions in millimetre.
- Please refer to Pages AL001 to AL003 of this sales brochure for notes, legend of the terms and abbreviations shown in the floor plan.
-  Dotted line in a residential unit with open kitchen delineates the extent of open kitchen area.

備註:

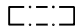
- 平面圖所列之尺寸數字為毫米標示的建築結構尺寸。
- 平面圖中顯示之備註、名詞及簡稱圖例請參閱本售樓說明書第AL001至AL003頁。
-  設有開放式廚房的住宅單位內所顯示的虛線代表開放式廚房範圍。

FLOOR PLANS OF RESIDENTIAL PROPERTIES IN THE PHASE 期數的住宅物業的樓面平面圖

FISKARS TOWER 2A 29/F-33/F | FISKARS 第2A座 29樓至33樓



FISKARS TOWER 2B
FISKARS 第2B座

TWO AIR-CONDITIONERS OUTDOOR UNITS WILL BE INSTALLED WITH A DOUBLE DECK SYSTEM
兩部冷氣機室外機將會以雙層系統型式安裝

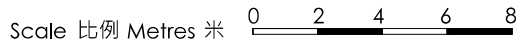

FLOOR PLANS OF RESIDENTIAL PROPERTIES IN THE PHASE 期數的住宅物業的樓面平面圖

| | | Floor 樓層 | Flat 單位 | | | | | | | | |
|------------------------------------|--|-------------------------|---------------------------------|---------------------------------|------------------------|------------------------|------------------------|---------------------------------|------------------------|---------------------------------|---------------------|
| | | | A1 | A2 | B | C | D | E | F | G | |
| Fiskars Tower 2A Fiskars 第 2A 座 | Floor-to-floor height of each residential property (mm) 每個住宅物業的層與層之間的高度 (毫米) | 29/F-32/F 29 樓至 32 樓 | 2850, 2900, 3050, 3150 | 2700, 2850, 3050, 3150 | 2850, 3050, 3150 | 2850, 3050, 3150 | 2850, 3050, 3150 | 2850, 3050, 3150 | 2850, 3050, 3150 | 2850, 2900, 3050, 3150 | |
| | | 33/F 33 樓 | 3175, 3345, 3500 | 3175, 3200, 3395, 3500 | 3200, 3400, 3500 | 3200, 3400, 3500 | 3200, 3400, 3500 | 3200, 3395, 3400, 3500 | 3395, 3500 | 3200, 3395, 3400, 3500 | |
| | The thickness of the floor slabs (excluding plaster) of each residential property (mm) 每個住宅物業的樓板的厚度 (不包括灰泥)(毫米) | 29/F-32/F 29 樓至 32 樓 | 150, 175 | 150, 175 | 150, 175 | 150, 175 | 150, 175 | 150, 175 | 150, 175 | 175, 200, 500 | 150, 175, 450 |
| | | 33/F 33 樓 | 150, 175 | 150, 200 | 150, 175 | 150, 175 | 150, 175 | 150, 175 | 150, 175 | 150, 200 | 150 |

The internal areas of the residential properties on the upper floors will generally be slightly larger than those on the lower floors because of the reducing thickness of the structural walls on the upper floors. (This does not apply to the residential properties in the Phase because the design of the Phase does not involve reducing thickness of structural walls of residential properties on the upper floors and hence internal areas of those residential properties will not be increased.)

因住宅物業的較高樓層的結構牆的厚度遞減，較高樓層的內部面積，一般比較低樓層的內部面積稍大。(不適用於期數內的住宅物業，因為期數的設計是不牽涉較高樓層的住宅物業的結構牆的厚度遞減。因此，該等住宅物業的內部面積不會增加。)

Notes:

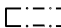
- The dimensions of floor plans are all structural dimensions in millimetre.
- Please refer to Pages AL001 to AL003 of this sales brochure for notes, legend of the terms and abbreviations shown in the floor plan.
-  Dotted line in a residential unit with open kitchen delineates the extent of open kitchen area.

備註:

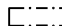
- 平面圖所列之尺寸數字為毫米標示的建築結構尺寸。
- 平面圖中顯示之備註、名詞及簡稱圖例請參閱本售樓說明書第AL001至AL003頁。
-  設有開放式廚房的住宅單位內所顯示的虛線代表開放式廚房範圍。

FLOOR PLANS OF RESIDENTIAL PROPERTIES IN THE PHASE 期數的住宅物業的樓面平面圖

FISKARS TOWER 2A PENTHOUSE FLOOR (35/F) | FISKARS 第2A座頂層(35樓)

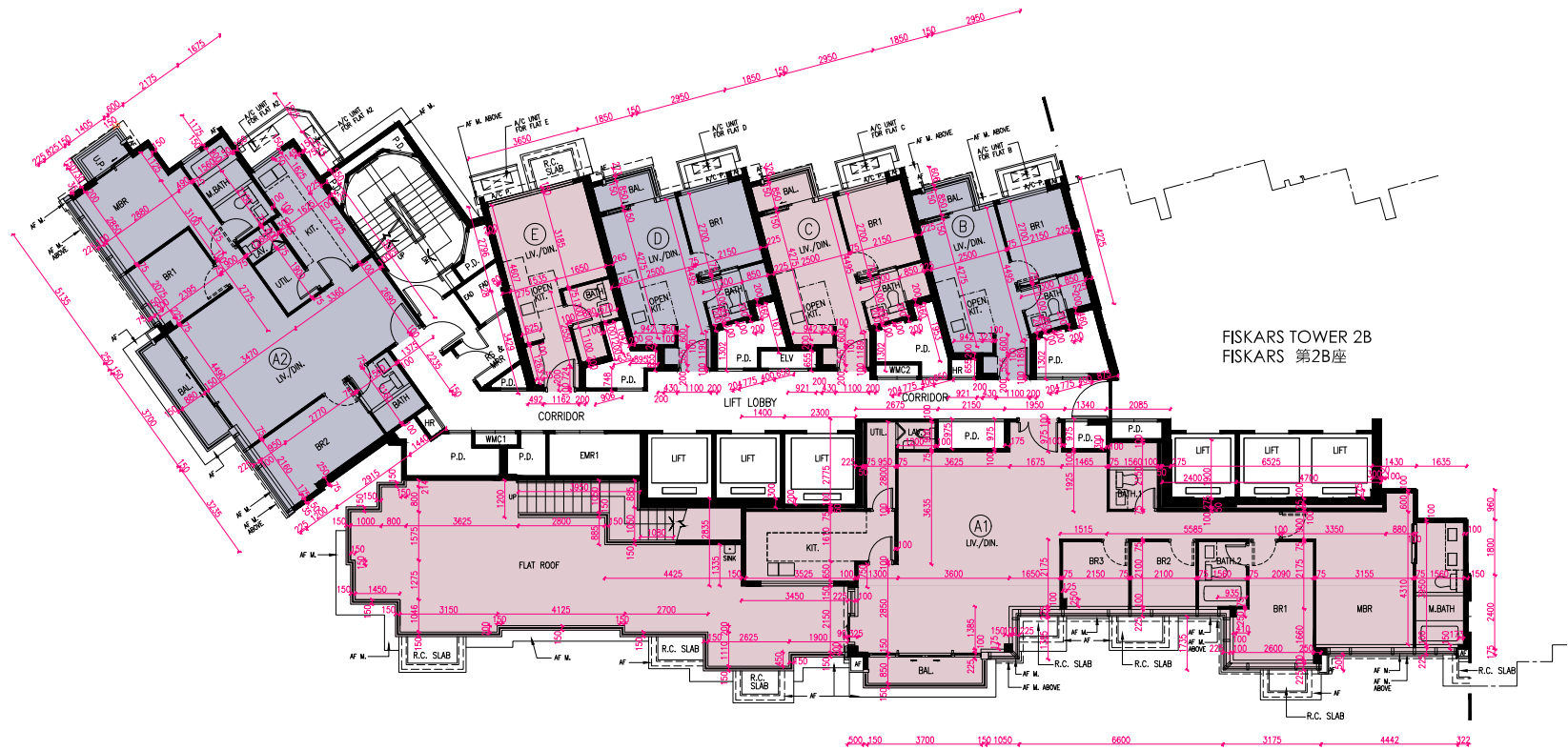

FISKARS TOWER 2B
FISKARS 第2B座

TWO AIR-CONDITIONERS OUTDOOR UNITS WILL BE INSTALLED WITH A DOUBLE DECK SYSTEM
兩部冷氣機室外機會以雙層系統型式安裝

Scale 比例 Metres 米 0 2 4 6 8

FLOOR PLANS OF RESIDENTIAL PROPERTIES IN THE PHASE 期數的住宅物業的樓面平面圖

| | | Floor 樓層 | Flat 單位 | | | | | |
|------------------------------------|--|-------------------------------------|------------------------|---------------------|------------------------|------------------------|------------------------|---------------|
| | | | A1 | A2 | B | C | D | E |
| Fiskars Tower 2A Fiskars 第 2A 座 | Floor-to-floor height of each residential property (mm) 每個住宅物業的層與層之間的高度 (毫米) | Penthouse Floor (35/F) 頂層 (35 樓) | 3850, 4050, 4075 | 3850, 4075 | 3850, 3970, 4050 | 3850, 3970, 4050 | 3850, 3970, 4050 | 3850, 4050 |
| | The thickness of the floor slabs (excluding plaster) of each residential property (mm) 每個住宅物業的樓板的厚度 (不包括灰泥)(毫米) | Penthouse Floor (35/F) 頂層 (35 樓) | 150, 200, 400 | 150, 200, 250 | 150, 200 | 150, 200 | 150, 200 | 200, 400 |

The internal areas of the residential properties on the upper floors will generally be slightly larger than those on the lower floors because of the reducing thickness of the structural walls on the upper floors. (This does not apply to the residential properties in the Phase because the design of the Phase does not involve reducing thickness of structural walls of residential properties on the upper floors and hence internal areas of those residential properties will not be increased.)

因住宅物業的較高樓層的結構牆的厚度遞減，較高樓層的內部面積，一般比較低樓層的內部面積稍大。（不適用於期數內的住宅物業，因為期數的設計是不牽涉較高樓層的住宅物業的結構牆的厚度遞減。因此，該等住宅物業的內部面積不會增加。）

Notes:

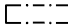
- The dimensions of floor plans are all structural dimensions in millimetre.
- Please refer to Pages AL001 to AL003 of this sales brochure for notes, legend of the terms and abbreviations shown in the floor plan.
-  Dotted line in a residential unit with open kitchen delineates the extent of open kitchen area.

備註:

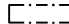
- 平面圖所列之尺寸數字為毫米標示的建築結構尺寸。
- 平面圖中顯示之備註、名詞及簡稱圖例請參閱本售樓說明書第AL001至AL003頁。
-  設有開放式廚房的住宅單位內所顯示的虛線代表開放式廚房範圍。

FLOOR PLANS OF RESIDENTIAL PROPERTIES IN THE PHASE 期數的住宅物業的樓面平面圖

FISKARS TOWER 2A ROOF | FISKARS 第2A座天台

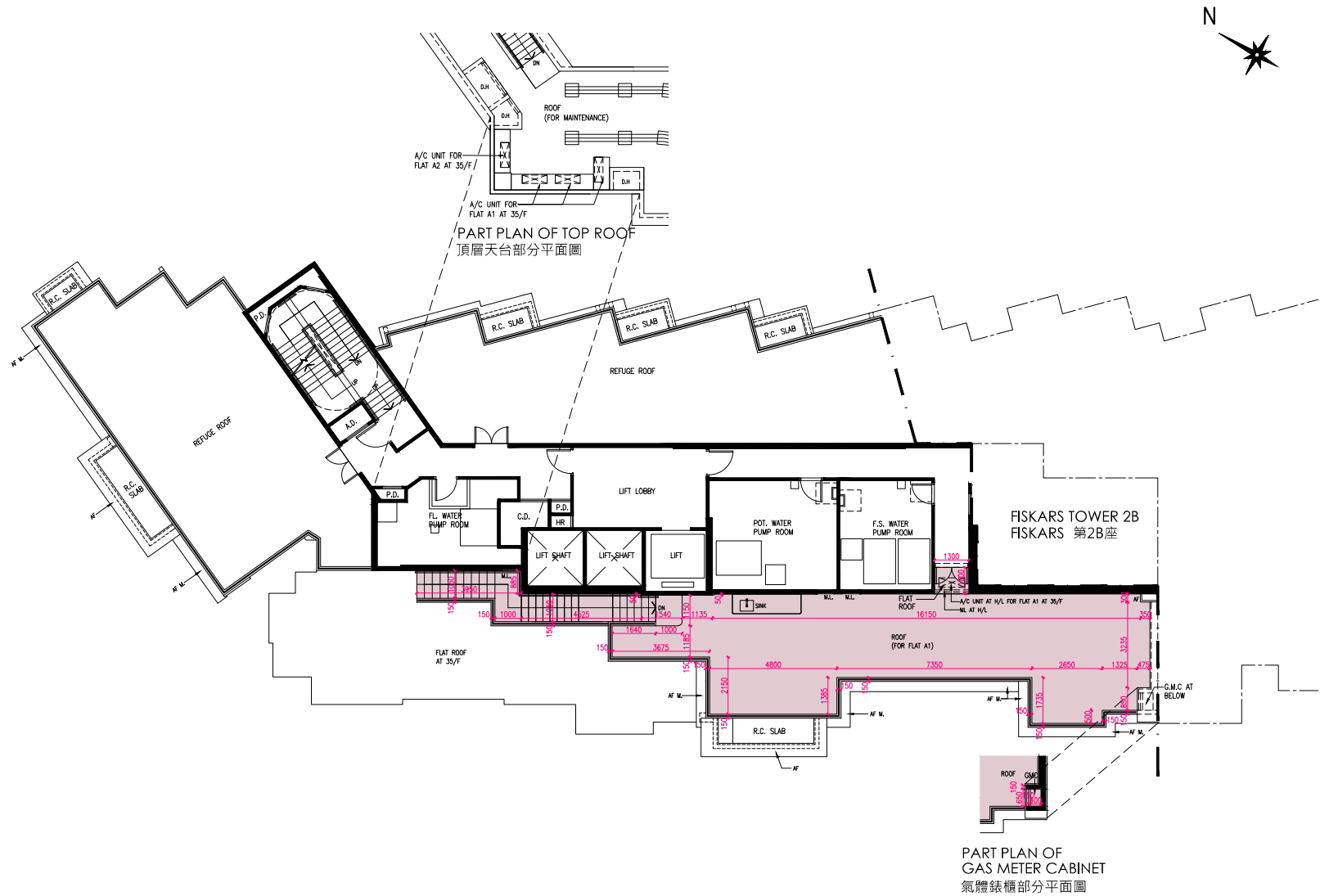

Scale 比例 Metres 米 0 2 4 6 8

FLOOR PLANS OF RESIDENTIAL PROPERTIES IN THE PHASE 期數的住宅物業的樓面平面圖

| | | Floor 樓層 | Flat 單位 A1 |
|----------------------------------|--|-------------|-----------------------|
| Fiskars Tower 2A Fiskars 第2A座 | Floor-to-floor height of each residential property (mm) 每個住宅物業的層與層之間的高度 (毫米) | Roof 天台 | Not Applicable 不適用 |
| | The thickness of the floor slabs (excluding plaster) of each residential property (mm) 每個住宅物業的樓板的厚度 (不包括灰泥)(毫米) | Roof 天台 | Not Applicable 不適用 |

The internal areas of the residential properties on the upper floors will generally be slightly larger than those on the lower floors because of the reducing thickness of the structural walls on the upper floors. (This does not apply to the residential properties in the Phase because the design of the Phase does not involve reducing thickness of structural walls of residential properties on the upper floors and hence internal areas of those residential properties will not be increased.)

因住宅物業的較高樓層的結構牆的厚度遞減，較高樓層的內部面積，一般比較低樓層的內部面積稍大。（不適用於期數內的住宅物業，因為期數的設計是不牽涉較高樓層的住宅物業的結構牆的厚度遞減。因此，該等住宅物業的內部面積不會增加。）

Notes:

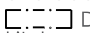
- The dimensions of floor plans are all structural dimensions in millimetre.
- Please refer to Pages AL001 to AL003 of this sales brochure for notes, legend of the terms and abbreviations shown in the floor plan.
-  Dotted line in a residential unit with open kitchen delineates the extent of open kitchen area.

備註:

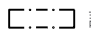
- 平面圖所列之尺寸數字為毫米標示的建築結構尺寸。
- 平面圖中顯示之備註、名詞及簡稱圖例請參閱本售樓說明書第AL001至AL003頁。
-  設有開放式廚房的住宅單位內所顯示的虛線代表開放式廚房範圍。

FLOOR PLANS OF RESIDENTIAL PROPERTIES IN THE PHASE 期數的住宅物業的樓面平面圖

FISKARS TOWER 2B GARDEN FLOOR (2/F) | FISKARS 第2B座 花園層 (2樓)

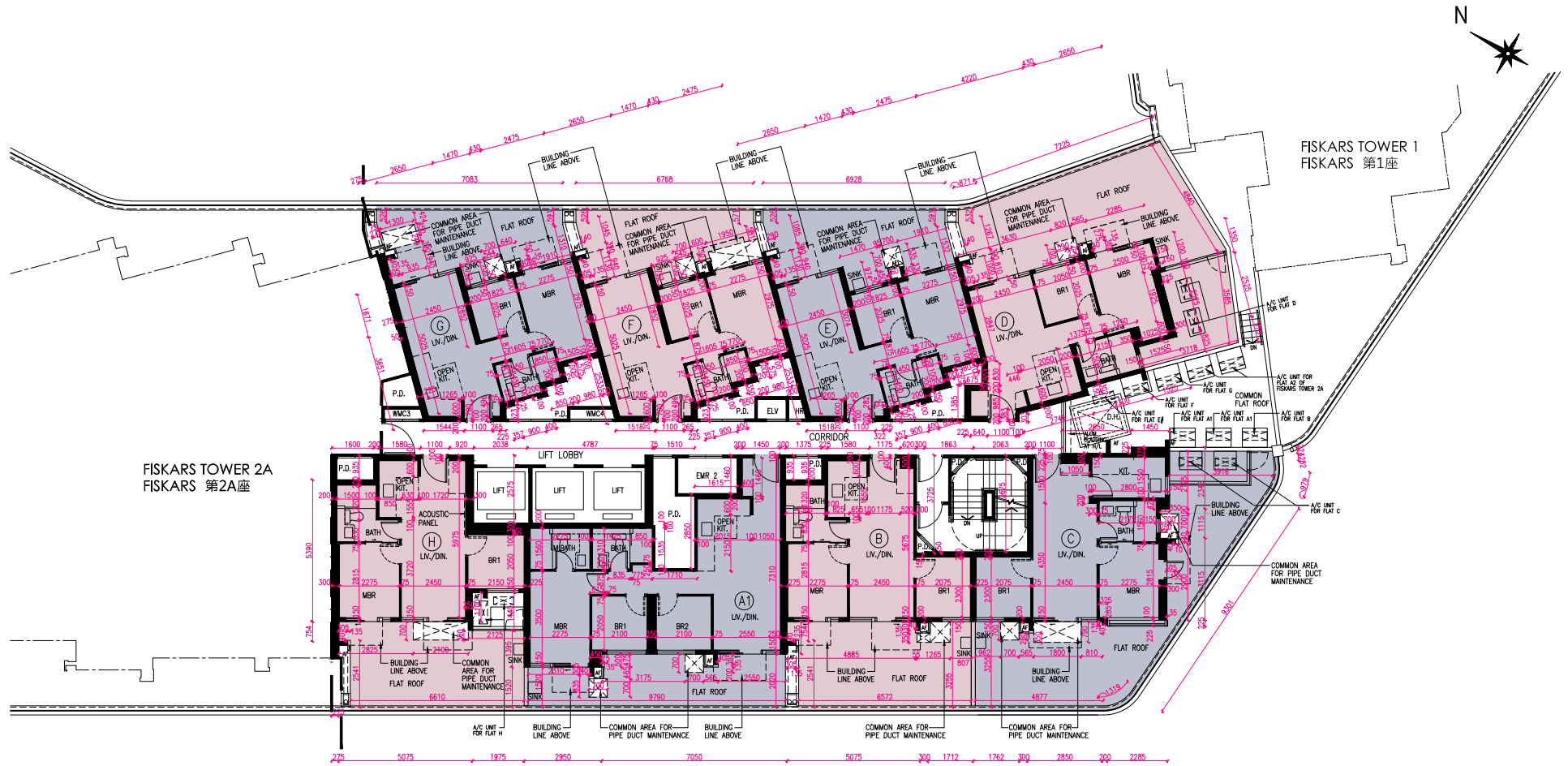

TWO AIR-CONDITIONERS OUTDOOR UNITS WILL BE INSTALLED WITH A DOUBLE DECK SYSTEM

兩部冷氣機室外機將會以雙層系統型式安裝

Scale 比例 Metres 米

FLOOR PLANS OF RESIDENTIAL PROPERTIES IN THE PHASE 期數的住宅物業的樓面平面圖

| | | Floor 樓層 | Flat 單位 | | | | | | | |
|------------------------------------|--|---------------------------------|---------------------------------|------------------------|---------------------------------|------------------------|------------------------|------------------------|------------------------|------------------------|
| | | | A1 | B | C | D | E | F | G | H |
| Fiskars Tower 2B Fiskars 第 2B 座 | Floor-to-floor height of each residential property (mm) 每個住宅物業的層與層之間的高度 (毫米) | Garden Floor (2/F) 花園層 (2 樓) | 2700, 2850, 3050, 3150 | 2850, 3050, 3150 | 2850, 2900, 3050, 3150 | 2850, 3050, 3150 | 2850, 3050, 3150 | 2850, 3050, 3150 | 2850, 3050, 3150 | 2850, 3050, 3150 |
| | The thickness of the floor slabs (excluding plaster) of each residential property (mm) 每個住宅物業的樓板的厚度 (不包括灰泥)(毫米) | Garden Floor (2/F) 花園層 (2 樓) | 175 | 150, 175, 200 | 150, 175, 300 | 150, 175, 200 | 175, 275 | 175, 275 | 175, 275 | 175 |

The internal areas of the residential properties on the upper floors will generally be slightly larger than those on the lower floors because of the reducing thickness of the structural walls on the upper floors. (This does not apply to the residential properties in the Phase because the design of the Phase does not involve reducing thickness of structural walls of residential properties on the upper floors and hence internal areas of those residential properties will not be increased.)

因住宅物業的較高樓層的結構牆的厚度遞減，較高樓層的內部面積，一般比較低樓層的內部面積稍大。（不適用於期數內的住宅物業，因為期數的設計是不牽涉較高樓層的住宅物業的結構牆的厚度遞減。因此，該等住宅物業的內部面積不會增加。）

Notes:

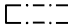
- The dimensions of floor plans are all structural dimensions in millimetre.
- Please refer to Pages AL001 to AL003 of this sales brochure for notes, legend of the terms and abbreviations shown in the floor plan.
-  Dotted line in a residential unit with open kitchen delineates the extent of open kitchen area.

備註:

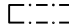
- 平面圖所列之尺寸數字為毫米標示的建築結構尺寸。
- 平面圖中顯示之備註、名詞及簡稱圖例請參閱本售樓說明書第AL001至AL003頁。
-  設有開放式廚房的住宅單位內所顯示的虛線代表開放式廚房範圍。

FLOOR PLANS OF RESIDENTIAL PROPERTIES IN THE PHASE 期數的住宅物業的樓面平面圖

FISKARS TOWER 2B 3/F, 5/F-12/F, 15/F-23/F & 25/F-28/F | FISKARS 第2B座 3樓、5樓至12樓、15樓至23樓及25樓至28樓

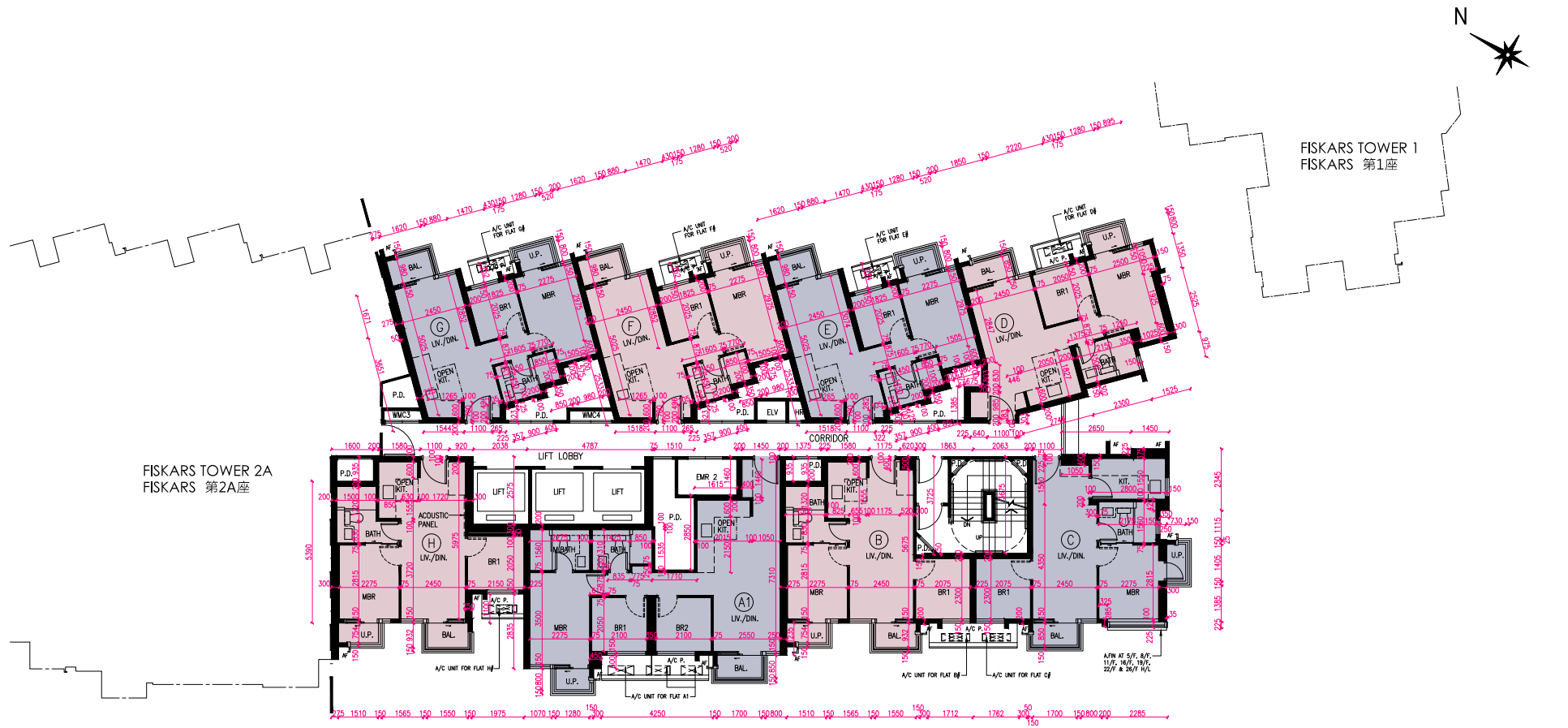

TWO AIR-CONDITIONERS OUTDOOR UNITS WILL BE INSTALLED WITH A DOUBLE DECK SYSTEM
 # 兩部冷氣機室外機將會以雙層系統型式安裝

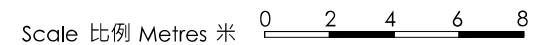

FLOOR PLANS OF RESIDENTIAL PROPERTIES IN THE PHASE 期數的住宅物業的樓面平面圖

| | | Floor 樓層 | Flat 單位 | | | | | | | |
|----------------------------------|--|---|---------------------------------|------------------------|---------------------------------|------------------------|------------------------|------------------------|------------------------|------------------------|
| | | | A1 | B | C | D | E | F | G | H |
| Fiskars Tower 2B Fiskars 第2B座 | Floor-to-floor height of each residential property (mm) 每個住宅物業的層與層之間的高度 (毫米) | 3/F, 5/F-12/F, 15/F-23/F & 25/F-27/F 3樓、5樓至12樓、 15樓至23樓及 25樓至27樓 | 2700, 2850, 3050, 3150 | 2850, 3050, 3150 | 2850, 2900, 3050, 3150 | 2850, 3050, 3150 | 2850, 3050, 3150 | 2850, 3050, 3150 | 2850, 3050, 3150 | 2850, 3050, 3150 |
| | Floor-to-floor height of each residential property (mm) 每個住宅物業的層與層之間的高度 (毫米) | 28/F 28樓 | 2700, 2850, 3050, 3150 | 2850, 3050, 3150 | 2850, 2900, 3050, 3150 | 2850, 3050, 3150 | 2850, 3050, 3150 | 2850, 3050, 3150 | 2850, 3050, 3150 | 2850, 3050, 3150 |
| | The thickness of the floor slabs (excluding plaster) of each residential property (mm) 每個住宅物業的樓板的厚度 (不包括灰泥)(毫米) | 3/F, 5/F-12/F, 15/F-23/F & 25/F-27/F 3樓、5樓至12樓、 15樓至23樓及 25樓至27樓 | 175 | 150, 175, 200 | 150, 175, 300 | 150, 175, 200 | 175, 275 | 175, 275 | 175, 275 | 175 |
| | The thickness of the floor slabs (excluding plaster) of each residential property (mm) 每個住宅物業的樓板的厚度 (不包括灰泥)(毫米) | 28/F 28樓 | 150, 175 | 150, 175, 200 | 150, 175 | 150, 175, 200 | 175, 275 | 175, 275 | 175, 275 | 175 |

The internal areas of the residential properties on the upper floors will generally be slightly larger than those on the lower floors because of the reducing thickness of the structural walls on the upper floors. (This does not apply to the residential properties in the Phase because the design of the Phase does not involve reducing thickness of structural walls of residential properties on the upper floors and hence internal areas of those residential properties will not be increased.)

因住宅物業的較高樓層的結構牆的厚度遞減，較高樓層的內部面積，一般比較低樓層的內部面積稍大。(不適用於期數內的住宅物業，因為期數的設計是不牽涉較高樓層的住宅物業的結構牆的厚度遞減。因此，該等住宅物業的內部面積不會增加。)

Notes:

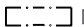
- The dimensions of floor plans are all structural dimensions in millimetre.
- Please refer to Pages AL001 to AL003 of this sales brochure for notes, legend of the terms and abbreviations shown in the floor plan.
-  Dotted line in a residential unit with open kitchen delineates the extent of open kitchen area.

備註:

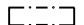
- 平面圖所列之尺寸數字為毫米標示的建築結構尺寸。
- 平面圖中顯示之備註、名詞及簡稱圖例請參閱本售樓說明書第AL001至AL003頁。
-  設有開放式廚房的住宅單位內所顯示的虛線代表開放式廚房範圍。

FLOOR PLANS OF RESIDENTIAL PROPERTIES IN THE PHASE 期數的住宅物業的樓面平面圖

FISKARS TOWER 2B 29/F-33/F | FISKARS 第2B座 29樓至33樓

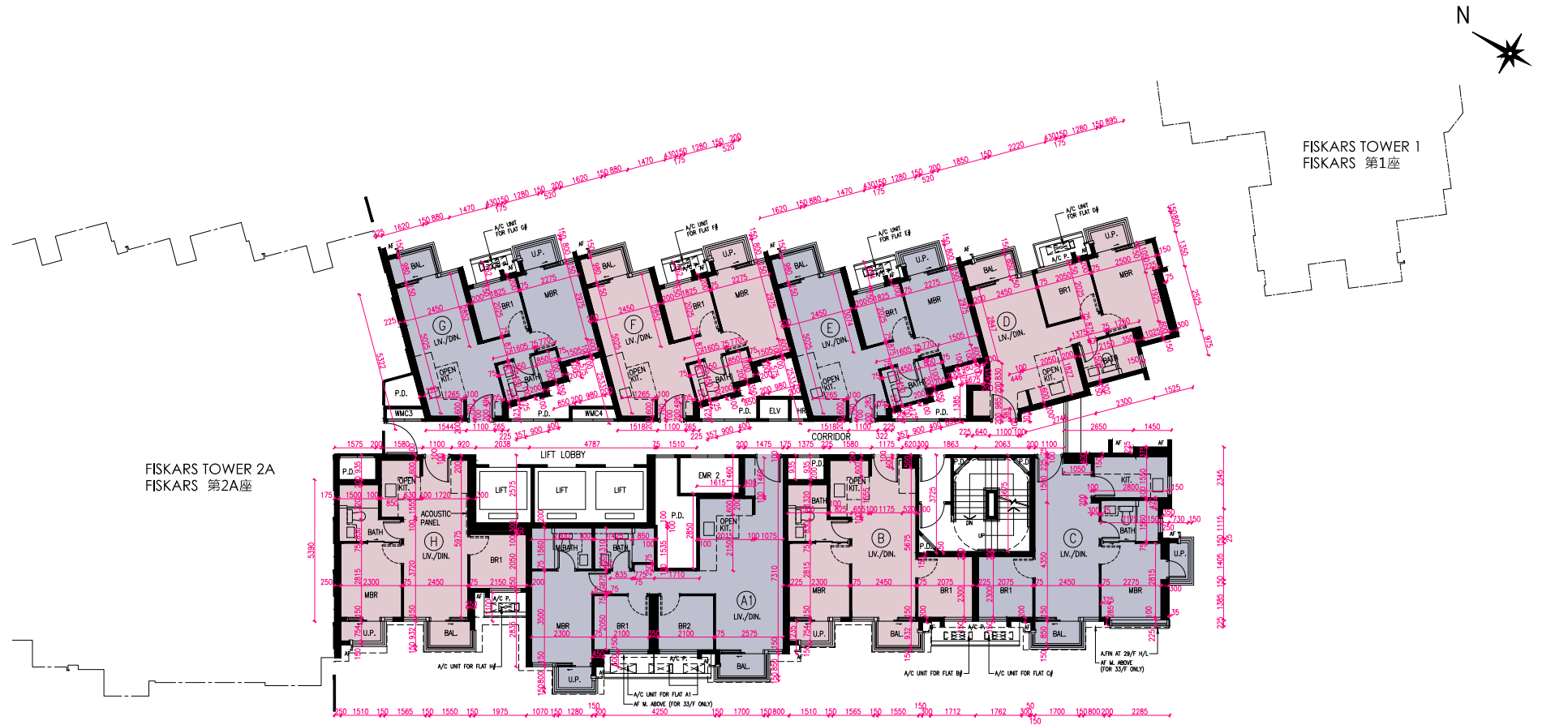

TWO AIR-CONDITIONERS OUTDOOR UNITS WILL BE INSTALLED WITH A DOUBLE DECK SYSTEM
 # 兩部冷氣機室外機將會以雙層系統型式安裝

Scale 比例 Metres 米 0 2 4 6 8

FLOOR PLANS OF RESIDENTIAL PROPERTIES IN THE PHASE 期數的住宅物業的樓面平面圖

| | | Floor 樓層 | Flat 單位 | | | | | | | |
|------------------------------------|--|-------------------------|---|------------------------|---------------------------------|------------------------|------------------------|------------------------|------------------------|--|
| | | | A1 | B | C | D | E | F | G | H |
| Fiskars Tower 2B Fiskars 第 2B 座 | Floor-to-floor height of each residential property (mm) 每個住宅物業的層與層之間的高度 (毫米) | 29/F-32/F 29 樓至 32 樓 | 2700, 2850, 3050, 3150 | 2850, 3050, 3150 | 2850, 2900, 3050, 3150 | 2850, 3050, 3150 | 2850, 3050, 3150 | 2850, 3050, 3150 | 2850, 3050, 3150 | 2850, 3050, 3150 |
| | Floor-to-floor height of each residential property (mm) 每個住宅物業的層與層之間的高度 (毫米) | 33/F 33 樓 | 3090, 3150, 3225, 3395, 3400, 3500 | 3395, 3500 | 3200, 3395, 3400, 3500 | 3200, 3400, 3500 | 3200, 3400, 3500 | 3200, 3400, 3500 | 3200, 3400, 3500 | 3100, 3150, 3200, 3400, 3500 |
| | The thickness of the floor slabs (excluding plaster) of each residential property (mm) 每個住宅物業的樓板的厚度 (不包括灰泥)(毫米) | 29/F-32/F 29 樓至 32 樓 | 150, 175 | 150, 175, 200 | 150, 175 | 150, 175, 200 | 175, 275 | 175, 275 | 175, 275 | 175 |
| | The thickness of the floor slabs (excluding plaster) of each residential property (mm) 每個住宅物業的樓板的厚度 (不包括灰泥)(毫米) | 33/F 33 樓 | 150, 175, 225, 500 | 150, 200 | 150, 200 | 150, 200 | 150, 175, 275 | 150, 175, 275 | 150, 175, 275 | 150, 200 |

The internal areas of the residential properties on the upper floors will generally be slightly larger than those on the lower floors because of the reducing thickness of the structural walls on the upper floors. (This does not apply to the residential properties in the Phase because the design of the Phase does not involve reducing thickness of structural walls of residential properties on the upper floors and hence internal areas of those residential properties will not be increased.)

因住宅物業的較高樓層的結構牆的厚度遞減，較高樓層的內部面積，一般比較低樓層的內部面積稍大。（不適用於期數內的住宅物業，因為期數的設計是不牽涉較高樓層的住宅物業的結構牆的厚度遞減。因此，該等住宅物業的內部面積不會增加。）

Notes:

- The dimensions of floor plans are all structural dimensions in millimetre.
- Please refer to Pages AL001 to AL003 of this sales brochure for notes, legend of the terms and abbreviations shown in the floor plan.
-  Dotted line in a residential unit with open kitchen delineates the extent of open kitchen area.

備註:

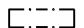
- 平面圖所列之尺寸數字為毫米標示的建築結構尺寸。
- 平面圖中顯示之備註、名詞及簡稱圖例請參閱本售樓說明書第AL001至AL003頁。
-  設有開放式廚房的住宅單位內所顯示的虛線代表開放式廚房範圍。

FLOOR PLANS OF RESIDENTIAL PROPERTIES IN THE PHASE 期數的住宅物業的樓面平面圖

FISKARS TOWER 2B PENTHOUSE FLOOR (35/F) | FISKARS 第2B座 頂層 (35樓)

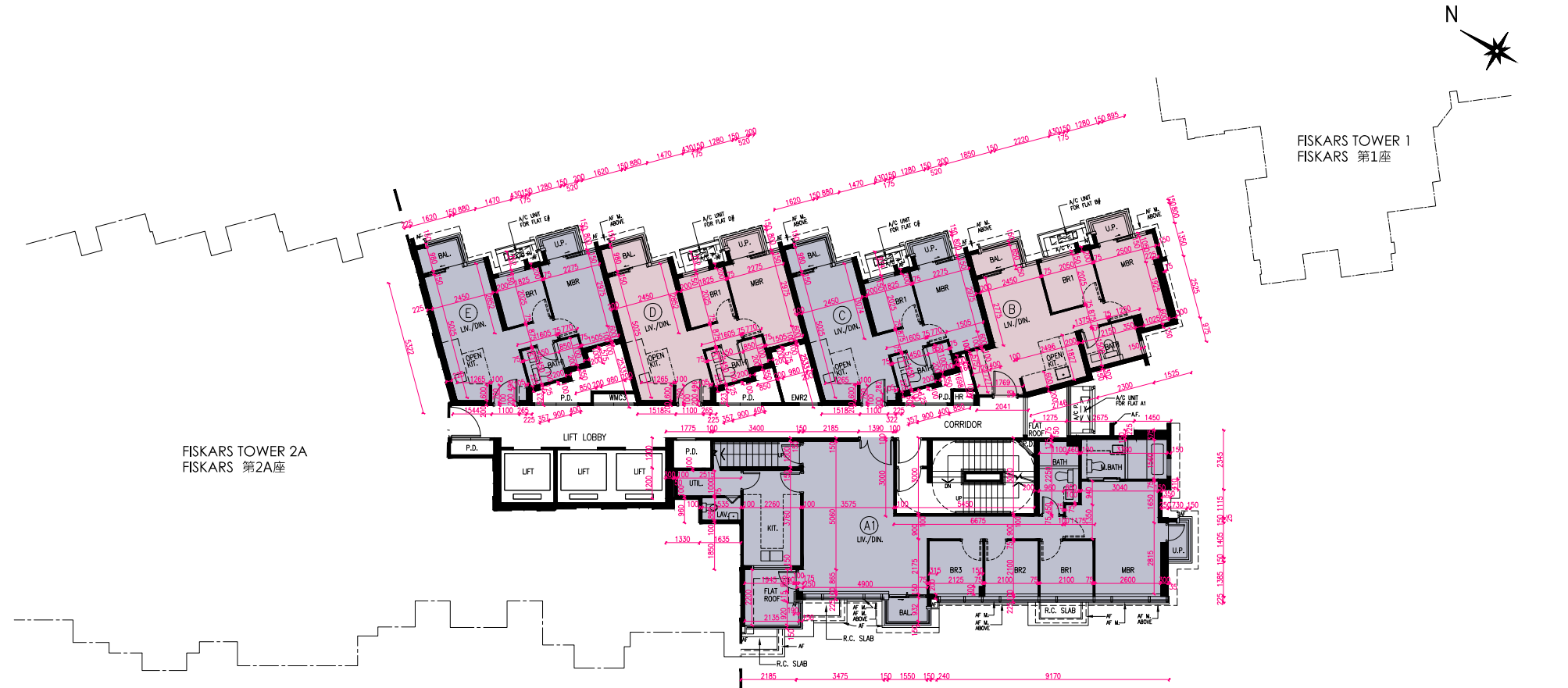

TWO AIR-CONDITIONERS OUTDOOR UNITS WILL BE INSTALLED WITH A DOUBLE DECK SYSTEM
 # 兩部冷氣機室外機將會以雙層系統型式安裝

Scale 比例 Metres 米 0 2 4 6 8

FLOOR PLANS OF RESIDENTIAL PROPERTIES IN THE PHASE 期數的住宅物業的樓面平面圖

| | | Floor 樓層 | Flat 單位 | | | | |
|------------------------------------|--|-------------------------------------|---------------|---------------------|---------------|---------------|------------------------|
| | | | A1 | B | C | D | E |
| Fiskars Tower 2B Fiskars 第 2B 座 | Floor-to-floor height of each residential property (mm) 每個住宅物業的層與層之間的高度 (毫米) | Penthouse Floor (35/F) 頂層 (35 樓) | 3850, 4075 | 3850, 3970 | 3850, 3970 | 3850, 3970 | 3850, 3970, 4050 |
| | The thickness of the floor slabs (excluding plaster) of each residential property (mm) 每個住宅物業的樓板的厚度 (不包括灰泥)(毫米) | Penthouse Floor (35/F) 頂層 (35 樓) | 150, 200 | 150, 200, 225 | 150, 200 | 150, 200 | 150, 200 |

The internal areas of the residential properties on the upper floors will generally be slightly larger than those on the lower floors because of the reducing thickness of the structural walls on the upper floors. (This does not apply to the residential properties in the Phase because the design of the Phase does not involve reducing thickness of structural walls of residential properties on the upper floors and hence internal areas of those residential properties will not be increased.)

因住宅物業的較高樓層的結構牆的厚度遞減，較高樓層的內部面積，一般比較低樓層的內部面積稍大。（不適用於期數內的住宅物業，因為期數的設計是不牽涉較高樓層的住宅物業的結構牆的厚度遞減。因此，該等住宅物業的內部面積不會增加。）

Notes:

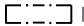
- The dimensions of floor plans are all structural dimensions in millimetre.
- Please refer to Pages AL001 to AL003 of this sales brochure for notes, legend of the terms and abbreviations shown in the floor plan.
-  Dotted line in a residential unit with open kitchen delineates the extent of open kitchen area.

備註:

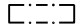
- 平面圖所列之尺寸數字為毫米標示的建築結構尺寸。
- 平面圖中顯示之備註、名詞及簡稱圖例請參閱本售樓說明書第AL001至AL003頁。
-  設有開放式廚房的住宅單位內所顯示的虛線代表開放式廚房範圍。

FLOOR PLANS OF RESIDENTIAL PROPERTIES IN THE PHASE 期數的住宅物業的樓面平面圖

FISKARS TOWER 2B ROOF | FISKARS 第2B座天台

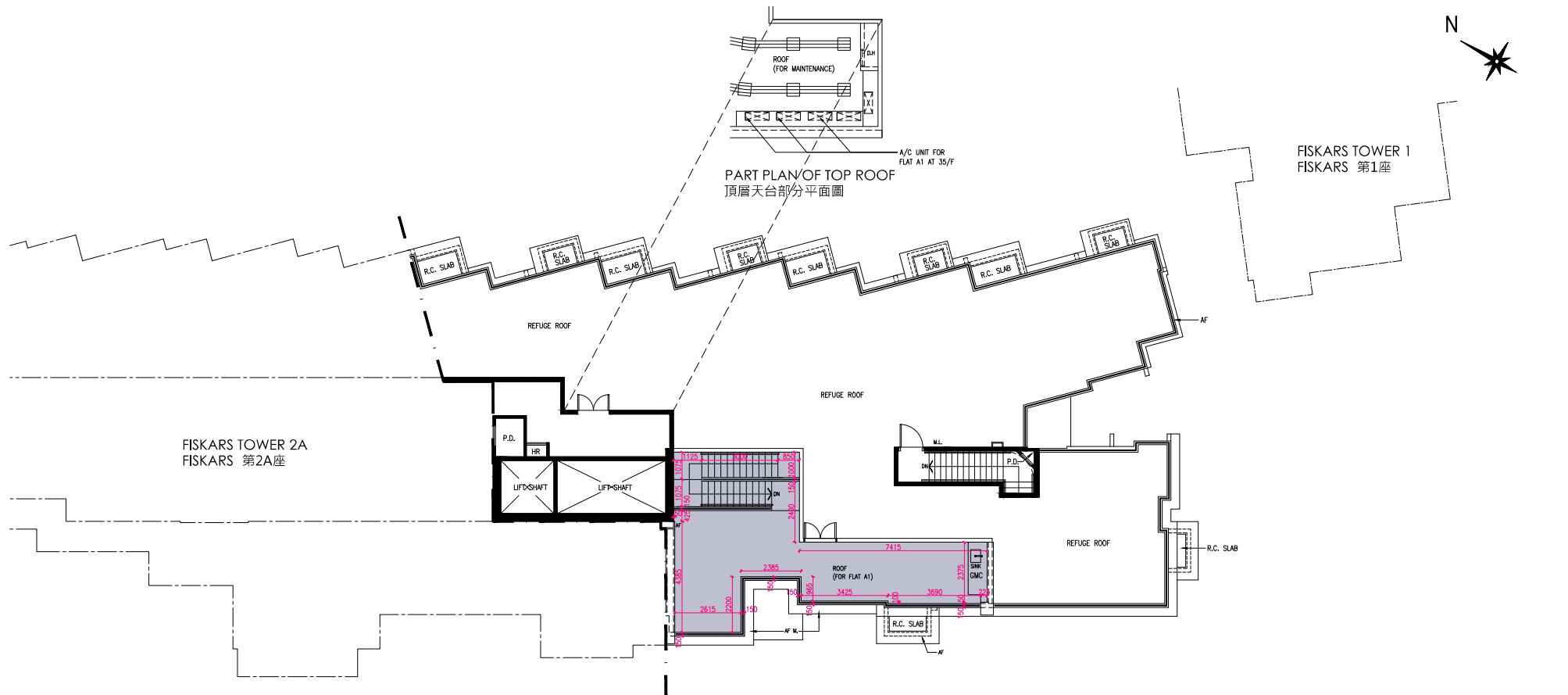

Scale 比例 Metres 米 0 2 4 6 8

FLOOR PLANS OF RESIDENTIAL PROPERTIES IN THE PHASE 期數的住宅物業的樓面平面圖

| | | Floor 樓層 | Flat 單位 A1 |
|------------------------------------|--|-------------|-----------------------|
| Fiskars Tower 2B Fiskars 第 2B 座 | Floor-to-floor height of each residential property (mm) 每個住宅物業的層與層之間的高度 (毫米) | Roof 天台 | Not Applicable 不適用 |
| | The thickness of the floor slabs (excluding plaster) of each residential property (mm) 每個住宅物業的樓板的厚度 (不包括灰泥)(毫米) | Roof 天台 | Not Applicable 不適用 |

The internal areas of the residential properties on the upper floors will generally be slightly larger than those on the lower floors because of the reducing thickness of the structural walls on the upper floors. (This does not apply to the residential properties in the Phase because the design of the Phase does not involve reducing thickness of structural walls of residential properties on the upper floors and hence internal areas of those residential properties will not be increased.)

因住宅物業的較高樓層的結構牆的厚度遞減，較高樓層的內部面積，一般比較低樓層的內部面積稍大。（不適用於期數內的住宅物業，因為期數的設計是不牽涉較高樓層的住宅物業的結構牆的厚度遞減。因此，該等住宅物業的內部面積不會增加。）

Notes:

- The dimensions of floor plans are all structural dimensions in millimetre.
- Please refer to Pages AL001 to AL003 of this sales brochure for notes, legend of the terms and abbreviations shown in the floor plan.
-  Dotted line in a residential unit with open kitchen delineates the extent of open kitchen area.

備註:

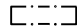
- 平面圖所列之尺寸數字為毫米標示的建築結構尺寸。
- 平面圖中顯示之備註、名詞及簡稱圖例請參閱本售樓說明書第AL001至AL003頁。
-  設有開放式廚房的住宅單位內所顯示的虛線代表開放式廚房範圍。