

# 7 LOCATION PLAN OF THE DEVELOPMENT

## 發展項目的所在位置圖

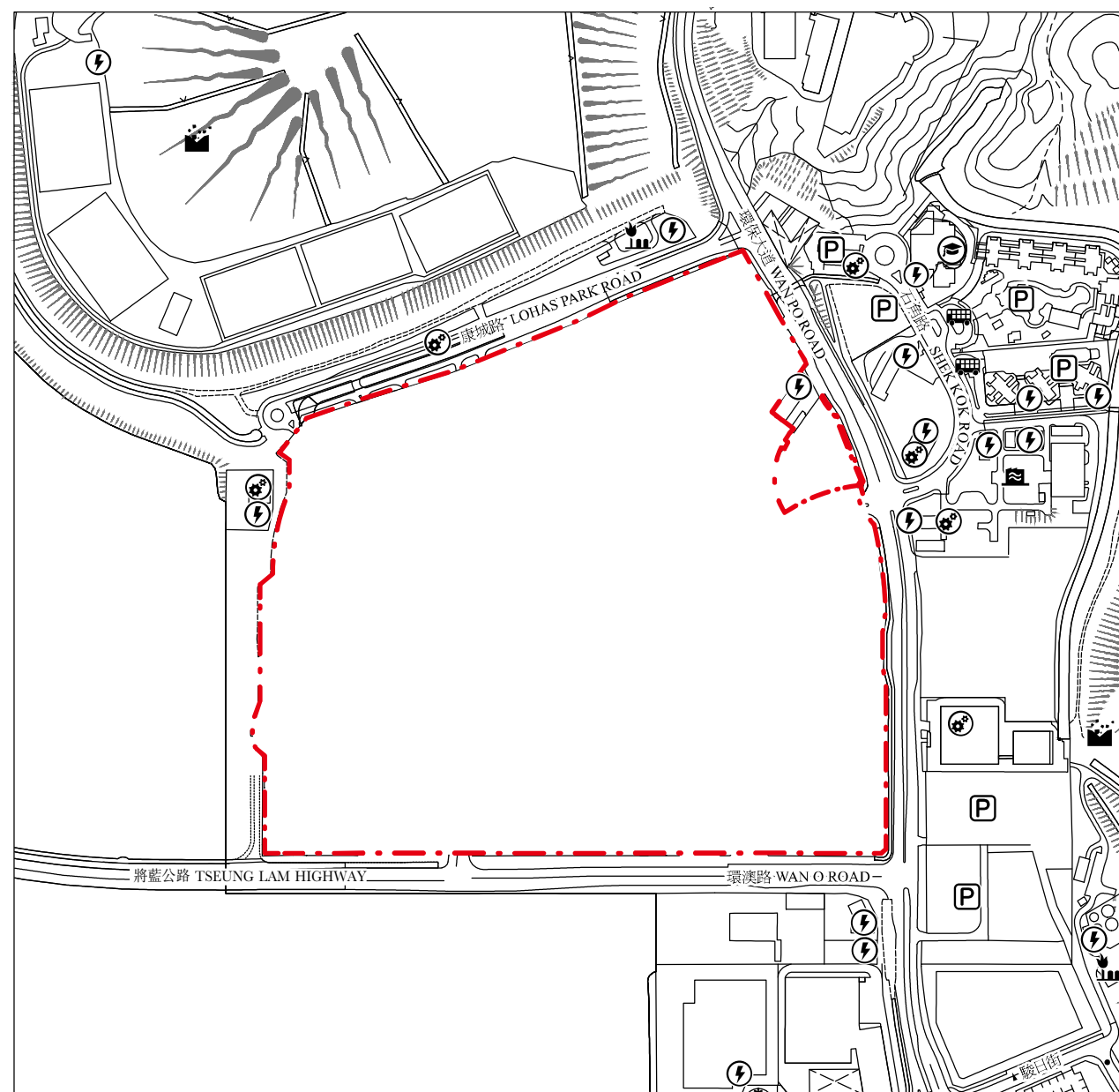

The Location Plan is made with reference to the Digital Topographic Map No. T12-SW-A dated 15 February 2024 from Survey and Mapping Office of the Lands Department with adjustments where necessary.

此位置圖是參考於2024年2月15日出版之地政總署測繪處之數碼地形圖，圖幅編號T12-SW-A編製，有需要處經修正處理。

### NOTATION 圖例

 Power Plant (including Electricity Sub-stations) 發電廠 (包括電力分站)	 Sewage Treatment Works and Facilities 污水處理廠及設施
 Public Carpark (including Lorry Park) 公眾停車場 (包括貨車停泊處)	 Landfills (including Ex-landfills) 堆填區 (包括已停用的堆填區)
 Public Transport Terminal (including Rail Station) 公共交通總站 (包括鐵路車站)	 Landfill Gas Flaring Plant 堆填區氣體燃燒廠
 Public Utility Installation 公用事業設施裝置	 School (including Kindergarten) 學校 (包括幼稚園)

 Location of the Development  
發展項目的位置

Scale : 0M/米 250M/米  
比例 

Street name(s) not shown in full in the Location Plan of the Development:

於發展項目的所在位置圖未能完全顯示之街道全名：

- Chun Sing Street 駿昇街
- ▲ Chun Yat Street 駿日街
- \* Chun Cheong Street 駿昌街

The Map is provided by the CSDI Portal and intellectual property rights are owned by the Government of the HKSAR.

地圖由空間數據共享平台提供，香港特別行政區政府為知識產權擁有人。

Notes:

1. The vendor advises prospective purchasers to conduct an on-site visit for a better understanding of the development, its surrounding environment and the public facilities nearby.
2. The location plan may show more than the area required under the Residential Properties (First-hand Sales) Ordinance due to the technical reason that the boundary of the Development is irregular.

附註：

1. 賣方建議準買家到有關發展項目地盤作實地考察，以對該發展項目、其周邊地區環境及附近的公共設施有較佳了解。
2. 由於發展項目的邊界不規則的技術原因，此位置圖所顯示的範圍可能超過《一手住宅物業銷售條例》所規定的範圍。