

Cross-section Plan A-A
橫截面圖A-A

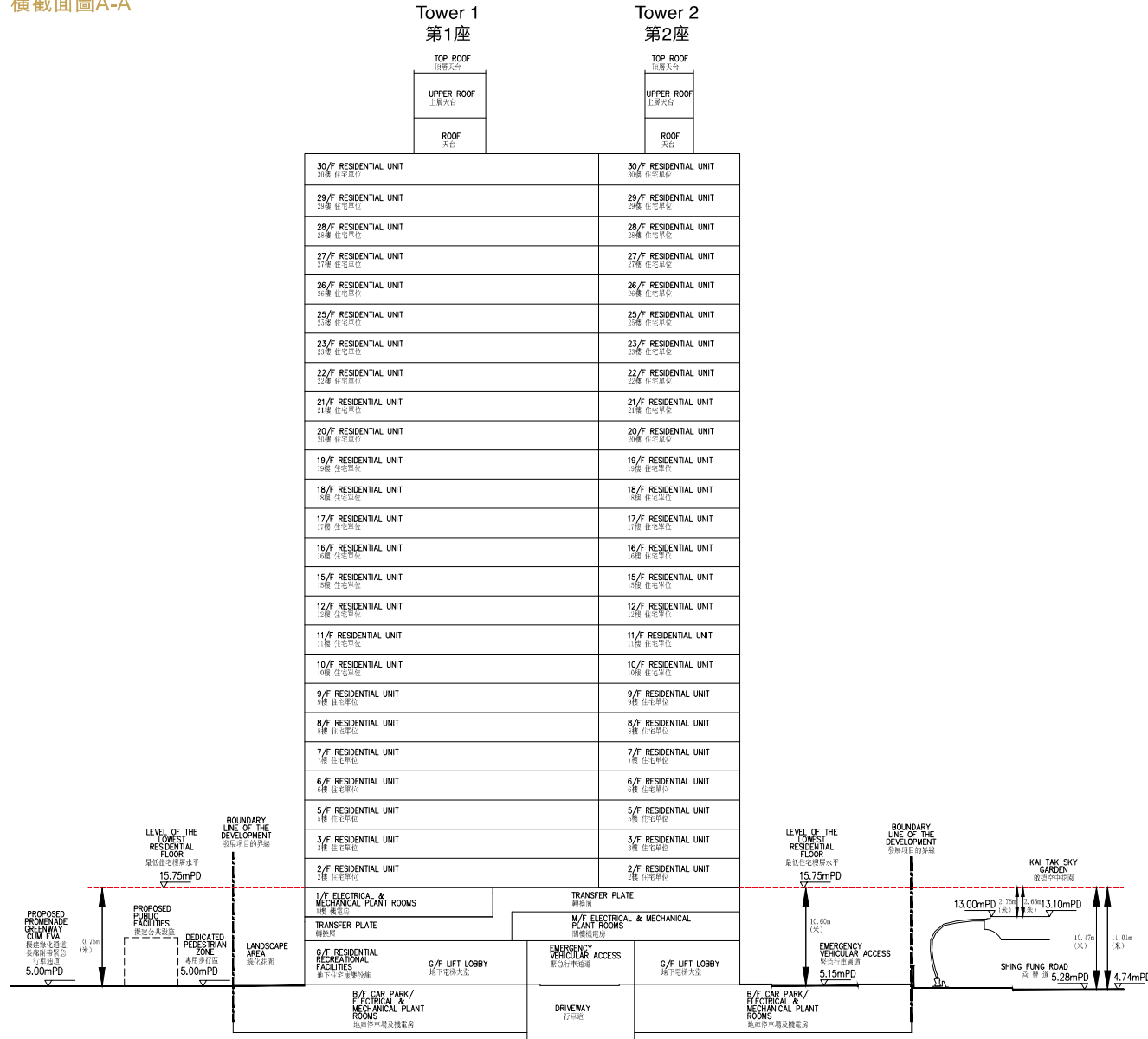

Key Plan
索引圖

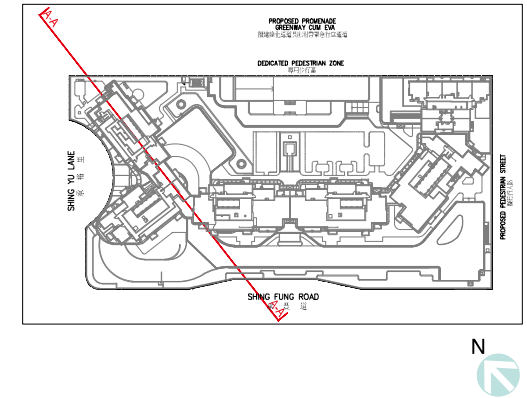

Legend 圖例

- Denotes height (in Metres) above the Hong Kong Principal Datum.
指香港主水平基準以上高度（米）。
- Dotted line denotes the lowest residential floor of the building.
虛線為該建築物最低住宅樓層水平。
- Boundary line of the Development.
發展項目的界線。

- The part of Dedicated Pedestrian Zone and proposed promenade greenway cum emergency vehicular access (EVA) adjacent to Tower 1 is 5.00 metres above the Hong Kong Principal Datum.
- 毗連第1座的一段專用步行區及擬建綠化通道長廊附帶緊急行車通道為香港主水平基準以上5.00米。
- The part of Emergency Vehicular Access adjacent to Tower 2 is 5.15 metres above the Hong Kong Principal Datum.
- 毗連第2座的一段緊急行車通道為香港主水平基準以上5.15米。
- The part of Shing Fung Road adjacent to Tower 2 is 4.74 metres to 5.28 metres above the Hong Kong Principal Datum.
- 毗連第2座的一段承豐道為香港主水平基準以上4.74米至5.28米。
- The part of Kai Tak Sky Garden adjacent to Tower 2 is 13.00 metres to 13.10 metres above the Hong Kong Principal Datum.
- 毗連第2座的一段啟德空中花園為香港主水平基準以上13.00米至13.10米。

Cross-section Plan B-B 橫截面圖B-B

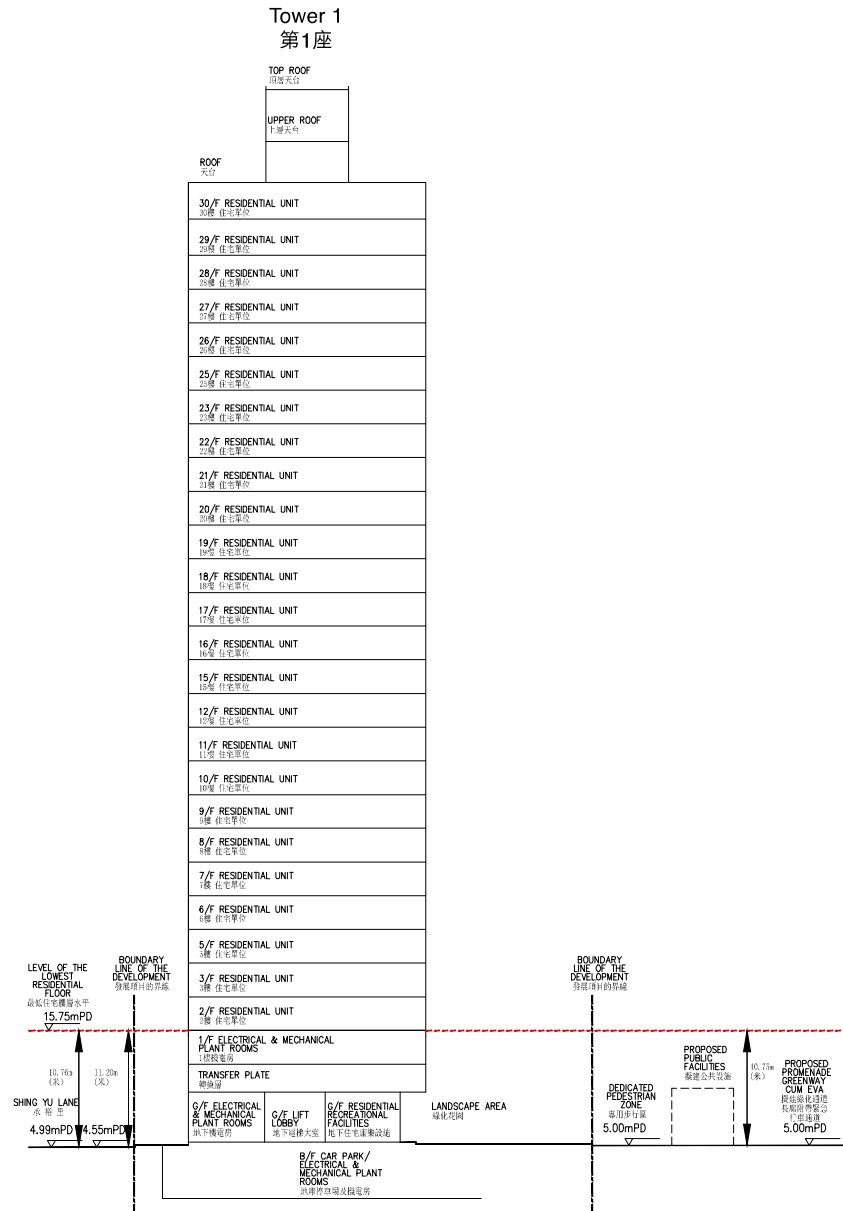

Key Plan 索引圖

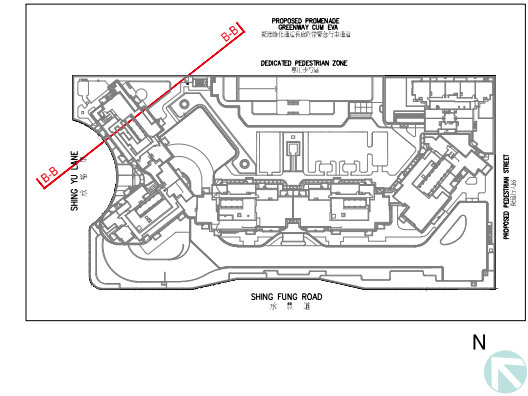

Legend 圖例



Denotes height (in Metres) above the Hong Kong Principal Datum.
指香港主水平基準以上高度 (米)。



Dotted line denotes the lowest residential floor of the building.
虛線為該建築物最低住宅樓層水平。



Boundary line of the Development.
發展項目的界線。

- The part of Dedicated Pedestrian Zone and proposed promenade greenway cum emergency vehicular access (EVA) adjacent to Tower 1 is 5.00 metres above the Hong Kong Principal Datum.
- 毗連第1座的一段專用步行區及擬建綠化通道長廊帶緊急車道為香港主水平基準以上5.00米。
- The part of Shing Yu Lane adjacent to Tower 1 is 4.55 metres to 4.99 metres above the Hong Kong Principal Datum.
- 毗連第1座的一段承裕里為香港主水平基準以上4.55米至4.99米。

Cross-section Plan C-C 橫截面圖C-C

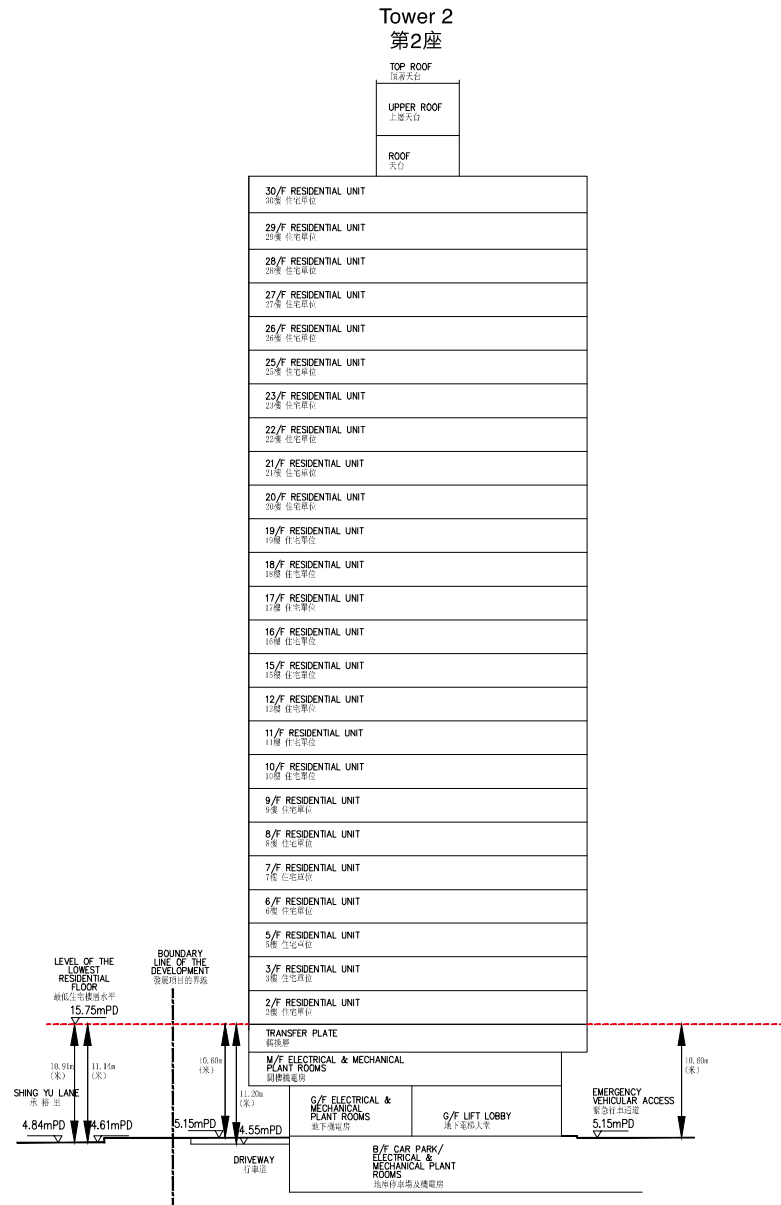

Key Plan 索引圖

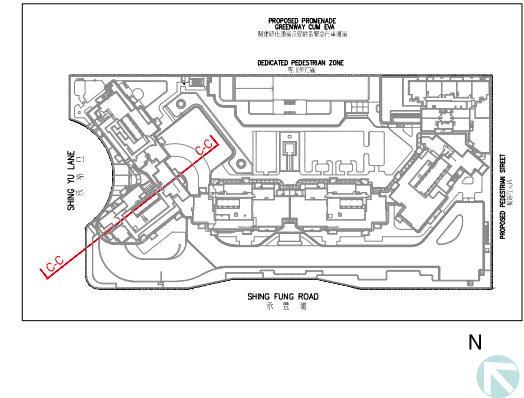

Legend 圖例



Denotes height (in Metres) above the Hong Kong Principal Datum.
指香港主水平基準以上高度 (米)。



Dotted line denotes the lowest residential floor of the building.
虛線為該建築物最低住宅樓層水平。



Boundary line of the Development.
發展項目的界線。

- The part of Emergency Vehicular Access adjacent to Tower 2 is 5.15 metres above the Hong Kong Principal Datum.
- 毗連第2座的一段緊急行車通道為香港主水平基準以上5.15米。
- The part of Driveway adjacent to Tower 2 is 4.55 metres to 5.15 metres above the Hong Kong Principal Datum.
- 毗連第2座的一段行車道為香港主水平基準以上4.55米至5.15米。
- The part of Shing Yu Lane adjacent to Tower 2 is 4.61 metres to 4.84 metres above the Hong Kong Principal Datum.
- 毗連第2座的一段承裕里為香港主水平基準以上4.61米至4.84米。

Cross-section Plan D-D
橫截面圖D-D

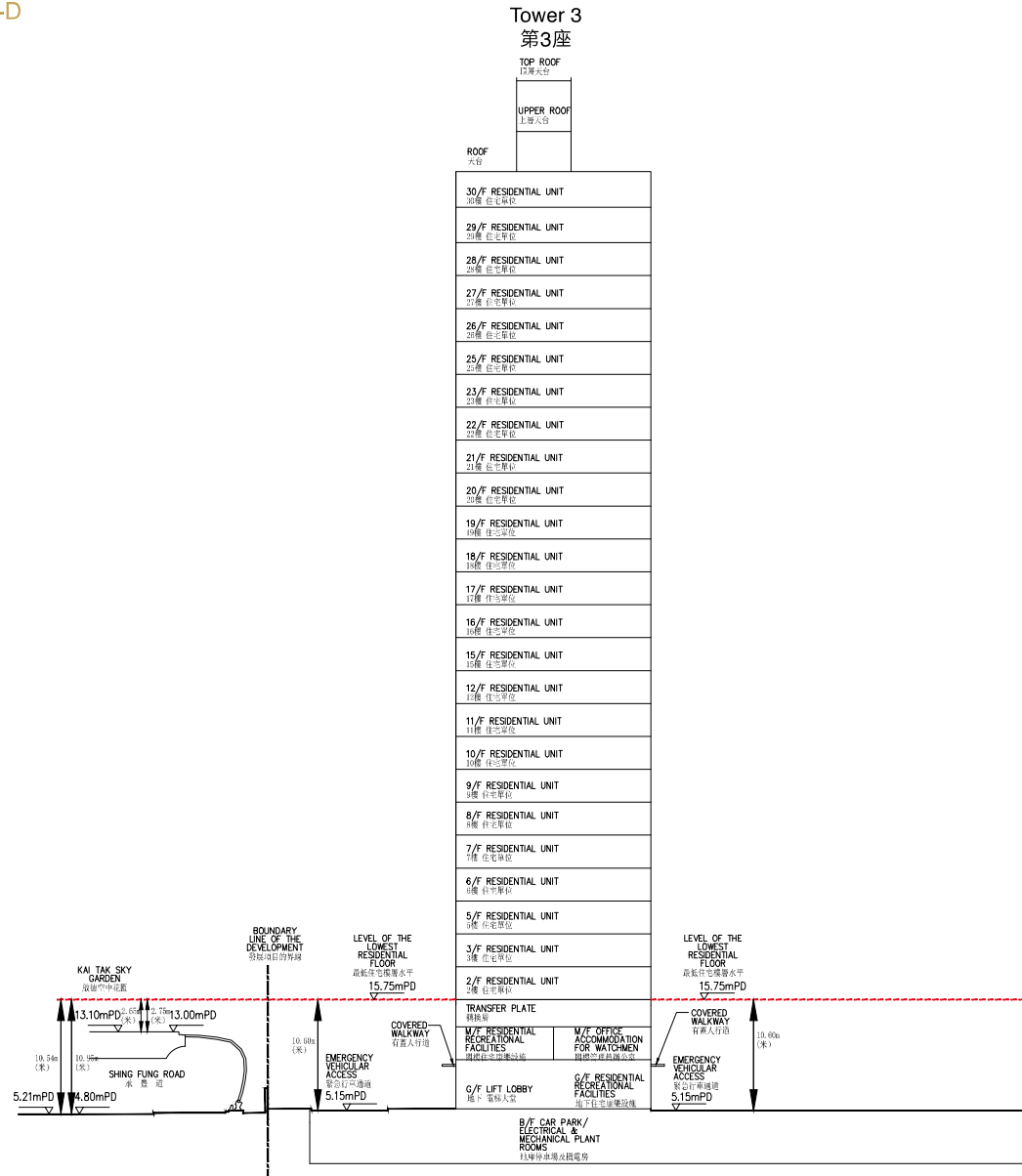

Key Plan
索引圖

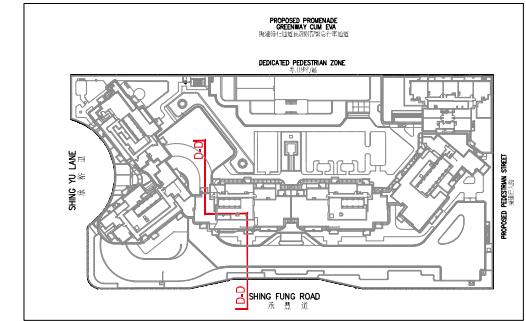

Legend 圖例



Denotes height (in Metres) above the Hong Kong Principal Datum.
指香港主水平基準以上高度（米）。



Dotted line denotes the lowest residential floor of the building.
虛線為該建築物最低住宅樓層水平。



Boundary line of the Development.
發展項目的界線。

- The part of Emergency Vehicular Access adjacent to Tower 3 is 5.15 metres above the Hong Kong Principal Datum.
- 毗連第3座的一段緊急行車通道為香港主水平基準以上5.15米。
- The part of Shing Fung Road adjacent to Tower 3 is 4.80 metres to 5.21 metres above the Hong Kong Principal Datum.
- 毗連第3座的一段承豐道為香港主水平基準以上4.80米至5.21米。
- The part of Kai Tak Sky Garden adjacent to Tower 3 is 13.00 metres to 13.10 metres above the Hong Kong Principal Datum.
- 毗連第3座的一段啟德空中花園為香港主水平基準以上13.00米至13.10米。