

CROSS-SECTION PLAN A
橫截面圖 A

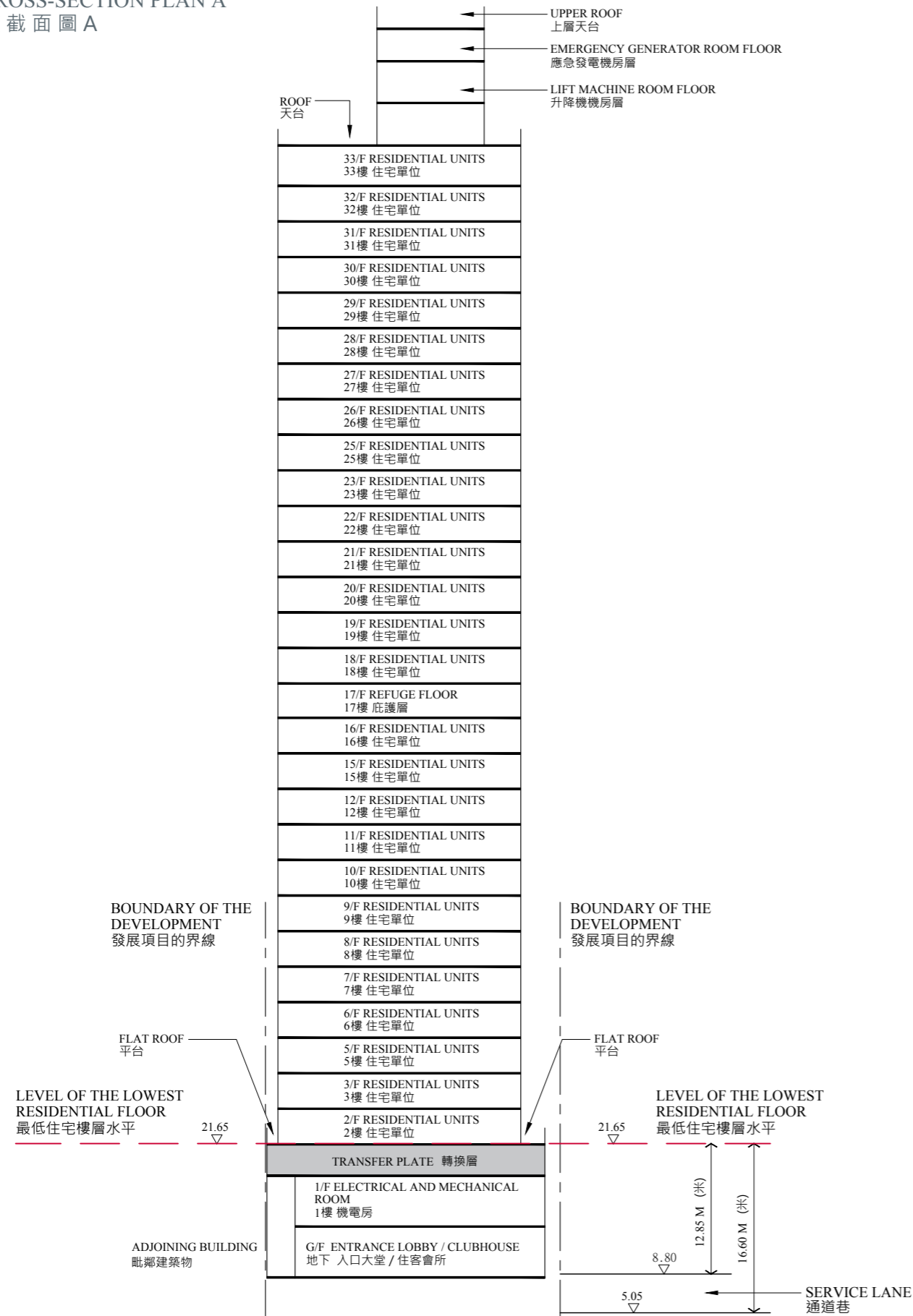

KEY PLAN 指示圖

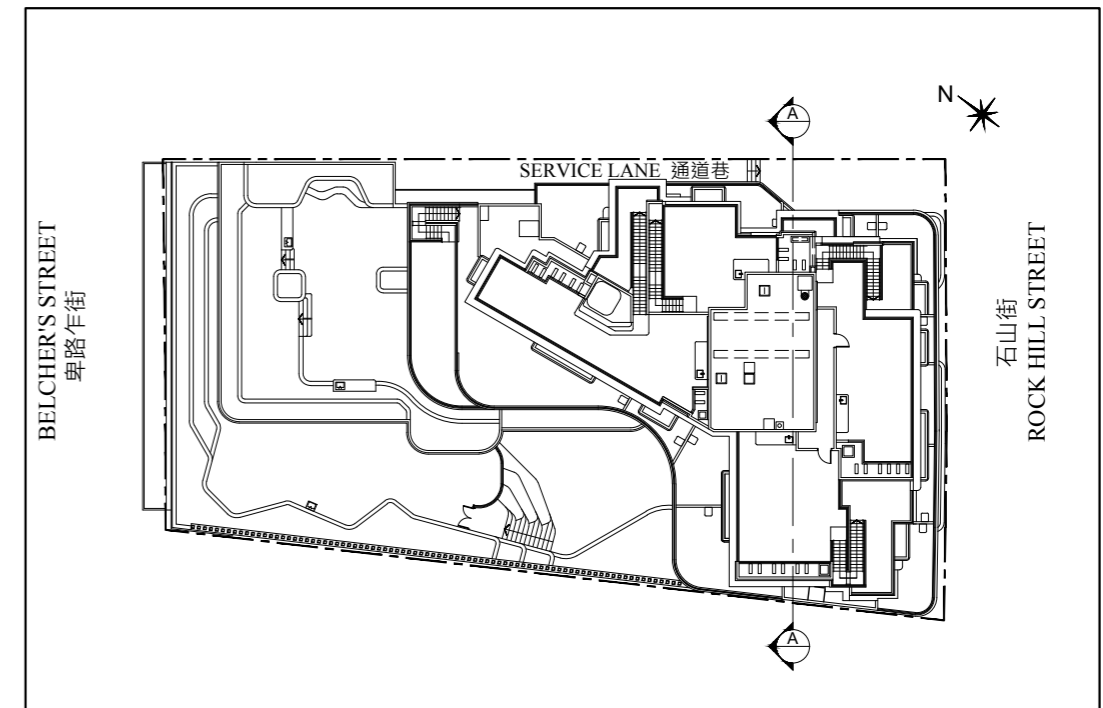

--- BOUNDARY OF THE DEVELOPMENT
發展項目的界線

1. The level of the lowest residential floor of the Development is 21.65 metres above the Hong Kong Principal Datum.
 2. The part of the service lane adjacent to the building is 5.05 metres to 8.80 metres above the Hong Kong Principal Datum.
 3. ∇ Denote height (in metres) above the Hong Kong Principal Datum (PD).
1. 發展項目之最低住宅樓層為香港主水平基準以上 21.65 米。
 2. 毗鄰建築物的一段通道巷為香港主水平基準以上 5.05 米至 8.80 米。
 3. ∇ 為香港主水平基準以上高度 (米)。

--- Dotted line denotes the level of the lowest residential floor.
虛線為最低住宅樓層水平。

CROSS-SECTION PLAN B
橫截面圖 B

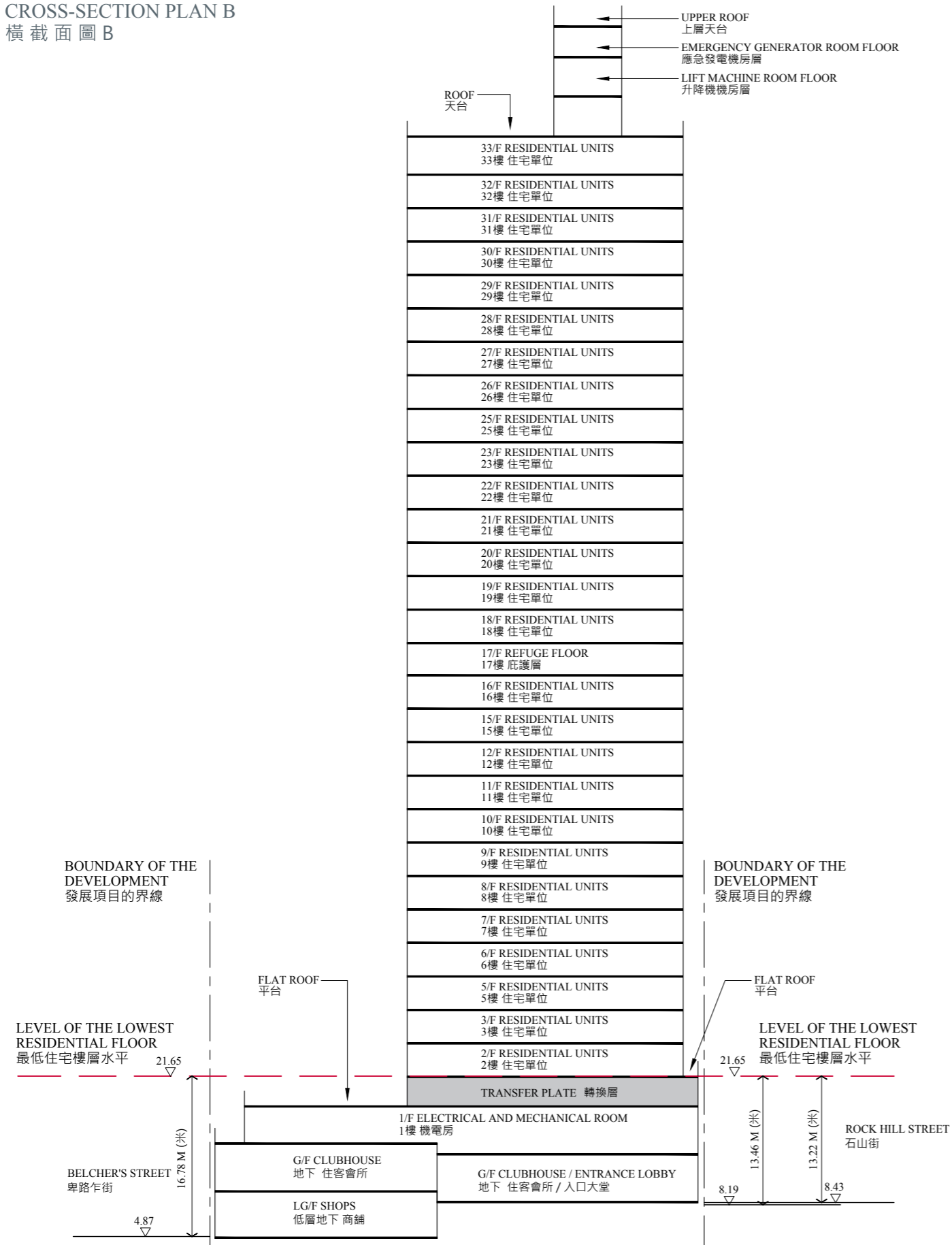

KEY PLAN 指示圖

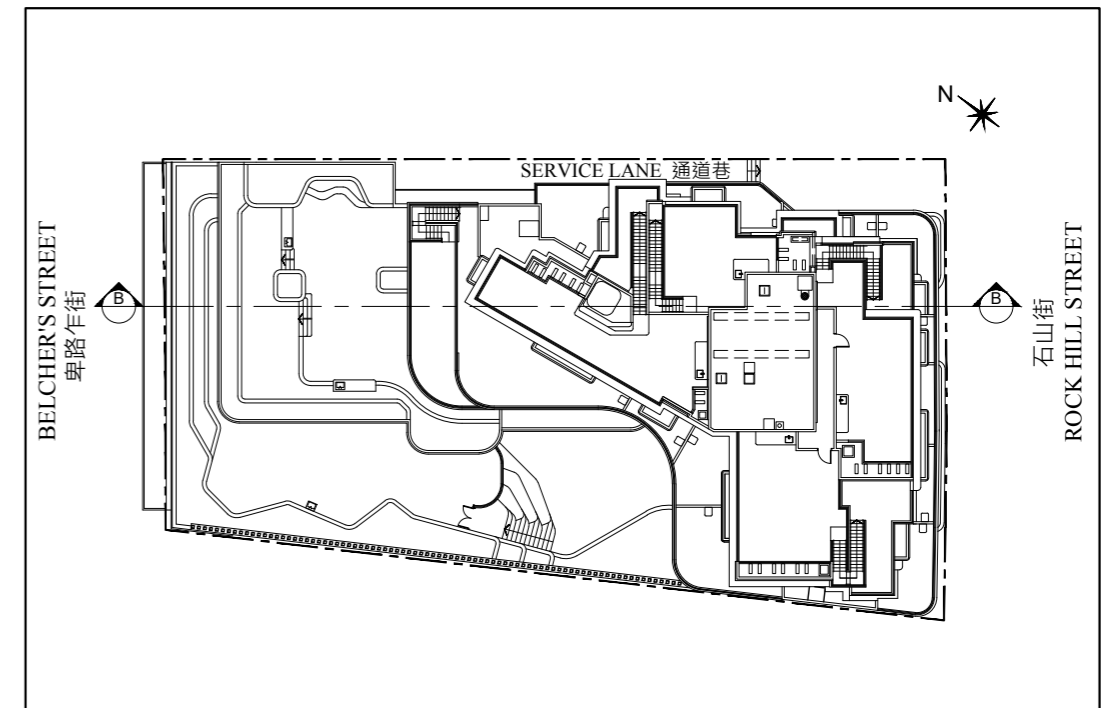

BOUNDARY OF THE DEVELOPMENT
發展項目的界線

1. The level of the lowest residential floor of the Development is 21.65 metres above the Hong Kong Principal Datum.
 2. The part of Belcher's Street adjacent to the building is 4.87 metres above the Hong Kong Principal Datum.
 3. The part of Rock Hill Street adjacent to the building is 8.19 metres to 8.43 metres above the Hong Kong Principal Datum.
 4. ▽ Denote height (in metres) above the Hong Kong Principal Datum (PD).
1. 發展項目之最低住宅樓層為香港主水平基準以上 21.65 米。
 2. 毗鄰建築物的一段卑路乍街為香港主水平基準以上 4.87 米。
 3. 毗鄰建築物的一段石山街為香港主水平基準以上 8.19 米至 8.43 米。
 4. ▽ 為香港主水平基準以上高度 (米)。

--- Dotted line denotes the level of the lowest residential floor.
虛線為最低住宅樓層水平。