

第2座 (2A & 2B)

柏傲莊 I 價單3號

2A座B室 (754呎/三房一套)

層數	訂價	建築期(-16.5%)
51	\$23,122,000	\$19,306,870
50	\$22,893,000	\$19,115,655
49	\$22,667,000	\$18,926,945
48	\$22,442,000	\$18,739,070
47	\$22,220,000	\$18,553,700
41	\$21,381,000	\$17,853,135
40	\$21,275,000	\$17,764,625
39	\$21,211,000	\$17,711,185
38	\$21,148,000	\$17,658,580
37	\$21,084,000	\$17,605,140
36	\$21,021,000	\$17,552,535
35	\$20,958,000	\$17,499,930
33	\$20,896,000	\$17,448,160
32	\$20,833,000	\$17,395,555
31	\$20,771,000	\$17,343,785
21	\$20,664,000	\$17,254,440
20	\$20,602,000	\$17,202,670
19	\$20,541,000	\$17,151,735
18	\$20,479,000	\$17,099,965

建築期折扣計算

建築期付款 (照售價)	--
New World CLUB 會員優惠	-3%
印花稅優惠	-8.5%
尊尚特選置業優惠	-5%
總共折扣:	-16.5%

2B座A室 (663呎/三房一套)

層數	訂價	建築期(-16.5%)
51	\$17,696,000	\$14,776,160
50	\$17,521,000	\$14,630,035
49	\$17,417,000	\$14,543,195
48	\$17,244,000	\$14,398,740
47	\$17,073,000	\$14,255,955
46	\$16,904,000	\$14,114,840
45	\$16,820,000	\$14,044,700
43	\$16,737,000	\$13,975,395
42	\$16,653,000	\$13,905,255
41	\$16,571,000	\$13,836,785
40	\$16,488,000	\$13,767,480
39	\$16,406,000	\$13,699,010
38	\$16,324,000	\$13,630,540
37	\$16,243,000	\$13,562,905
36	\$16,162,000	\$13,495,270
35	\$16,082,000	\$13,428,470
33	\$16,002,000	\$13,361,670
32	\$15,922,000	\$13,294,870
31	\$15,843,000	\$13,228,905

2B座B室 (663呎/三房一套)

層數	訂價	建築期(-16.5%)
51	\$17,873,000	\$14,923,955
50	\$17,696,000	\$14,776,160
49	\$17,591,000	\$14,688,485
48	\$17,417,000	\$14,543,195
47	\$17,244,000	\$14,398,740
46	\$17,073,000	\$14,255,955
45	\$16,989,000	\$14,185,815
43	\$16,904,000	\$14,114,840
42	\$16,820,000	\$14,044,700
41	\$16,736,000	\$13,974,560
40	\$16,653,000	\$13,905,255
39	\$16,570,000	\$13,835,950
38	\$16,488,000	\$13,767,480
37	\$16,406,000	\$13,699,010
36	\$16,324,000	\$13,630,540
35	\$16,243,000	\$13,562,905
33	\$16,162,000	\$13,495,270
32	\$16,082,000	\$13,428,470
31	\$16,002,000	\$13,361,670

2A座A室 (835呎/三房一套連儲物室)

層數	訂價	建築期(-16.5%)
51	\$26,720,000	\$22,311,200
50	\$26,455,000	\$22,089,925
49	\$26,193,000	\$21,871,155
48	\$25,934,000	\$21,654,890
47	\$25,677,000	\$21,440,295
41	\$24,696,000	\$20,621,160
40	\$24,573,000	\$20,518,455
39	\$24,451,000	\$20,416,585
38	\$24,378,000	\$20,355,630
37	\$24,305,000	\$20,294,675
36	\$24,232,000	\$20,233,720
35	\$24,160,000	\$20,173,600
33	\$24,087,000	\$20,112,645
32	\$24,015,000	\$20,052,525
31	\$23,944,000	\$19,993,240
21	\$23,655,000	\$19,751,925
20	\$23,584,000	\$19,692,640
19	\$23,513,000	\$19,633,355
18	\$23,443,000	\$19,574,905

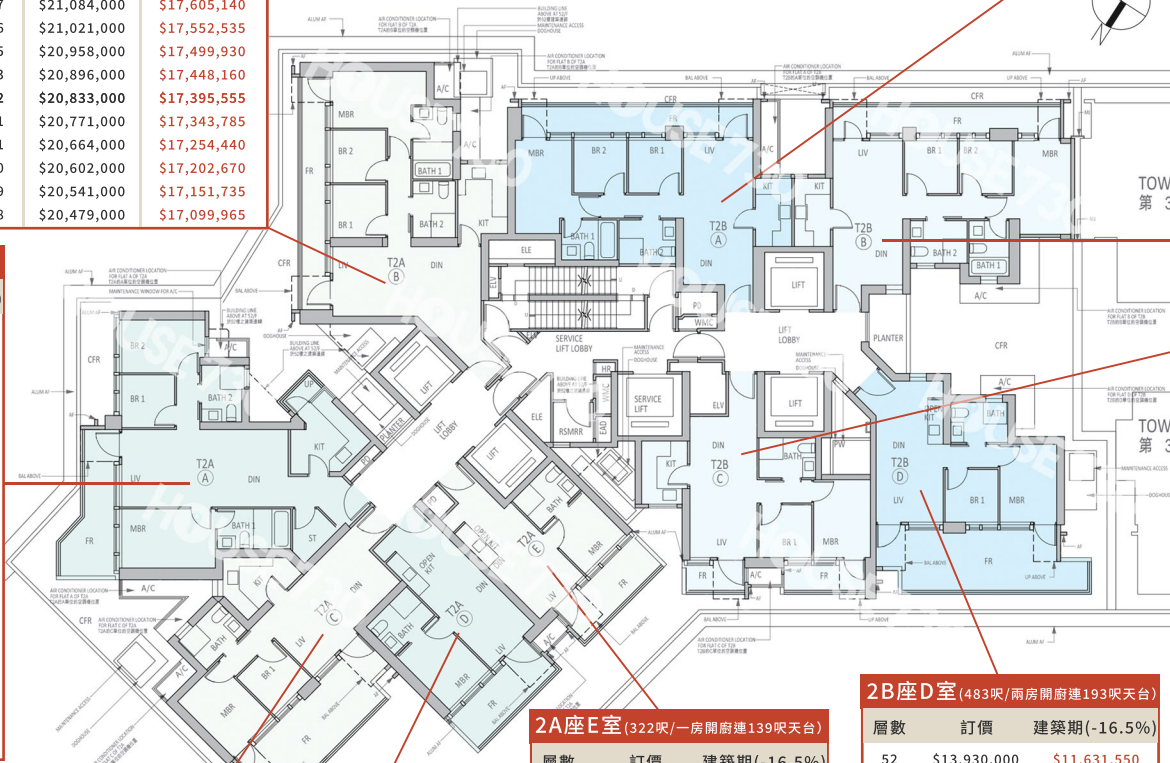

2B座C室 (519呎/兩房連180呎天台)

層數	訂價	建築期(-16.5%)
52	\$14,831,000	\$12,383,885

2B座C室 (523呎/兩房)

層數	訂價	建築期(-16.5%)
51	\$14,234,000	\$11,885,390
50	\$14,093,000	\$11,767,655
49	\$13,953,000	\$11,650,755
48	\$13,815,000	\$11,535,525
47	\$13,678,000	\$11,421,130
46	\$13,543,000	\$11,308,405
45	\$13,409,000	\$11,196,515
43	\$13,276,000	\$11,085,460
42	\$13,210,000	\$11,030,350
41	\$13,144,000	\$10,975,240
40	\$13,079,000	\$10,920,965
39	\$13,014,000	\$10,866,690
38	\$12,949,000	\$10,812,415
37	\$12,885,000	\$10,758,975
36	\$12,820,000	\$10,704,700
35	\$12,757,000	\$10,652,095
33	\$12,693,000	\$10,598,655
32	\$12,630,000	\$10,546,050
31	\$12,567,000	\$10,493,445
29	\$12,498,000	\$10,435,830
28	\$12,481,000	\$10,421,635
27	\$12,463,000	\$10,406,605
26	\$12,446,000	\$10,392,410
25	\$12,428,000	\$10,377,380
23	\$12,411,000	\$10,363,185
22	\$12,393,000	\$10,348,155
21	\$12,376,000	\$10,333,960
20	\$12,358,000	\$10,318,930

2B座C室 (523呎/兩房)

層數	訂價	建築期(-16.5%)
19	\$12,341,000	\$10,304,735
18	\$12,323,000	\$10,289,705
17	\$12,306,000	\$10,275,510
16	\$12,288,000	\$10,260,480
15	\$12,271,000	\$10,246,285
12	\$12,253,000	\$10,231,255
11	\$12,236,000	\$10,217,060
10	\$12,218,000	\$10,202,030
9	\$12,201,000	\$10,187,835
8	\$12,183,000	\$10,172,805

2B座C室 (485呎/兩房連52呎平台)

7	\$12,732,000	\$10,631,220
---	--------------	--------------

2A座C室 (495呎/兩房連148呎平台)

層數	訂價	建築期(-16.5%)
7	\$12,995,000	\$10,850,825

2A座D室 (352呎/一房開廚連201呎天台)

層數	訂價	建築期(-16.5%)
52	\$11,236,000	\$9,382,060
(350呎/一房開廚)		
51	\$10,773,000	\$8,995,455
(328呎/一房開廚連66呎平台)		
7	\$9,226,000	\$7,703,710

2A座E室 (322呎/一房開廚連139呎天台)

層數	訂價	建築期(-16.5%)
52	\$10,621,000	\$8,868,535
(322呎/一房開廚)		
51	\$10,115,000	\$8,446,025
50	\$10,095,000	\$8,429,325
49	\$10,075,000	\$8,412,625
48	\$9,975,000	\$8,329,125
47	\$9,955,000	\$8,312,425
46	\$9,935,000	\$8,295,725
45	\$9,915,000	\$8,279,025
43	\$9,895,000	\$8,262,325
42	\$9,876,000	\$8,246,460
41	\$9,856,000	\$8,229,760
40	\$9,836,000	\$8,213,060
(300呎/一房開廚連65呎平台)		
7	\$8,926,000	\$7,453,210

2B座D室 (483呎/兩房開廚連193呎天台)

層數	訂價	建築期(-16.5%)
52	\$13,930,000	\$11,631,550
(483呎/兩房開廚)		
51	\$13,267,000	\$11,077,945
(426呎/兩房開廚連170呎平台)		
7	\$12,142,000	\$10,138,570

資料來源: 柏傲莊I官網

製作日期: 2020年10月19日

以上製圖由House730製作

以上的物業資料只供參考, 一切以發展商最新公布為準, 如有任何資料錯誤House730不會承擔任何責任